

Title:	How to Set Wi-Fi Connection of Wi-Fi Camera via Mobile Phone Web Browser	Version:	V3.0	Date:	29/05/2023
Product:	Wi-Fi Camera			Page:	1 of 5

Preparation

1. Wi-Fi router, mobile phone
2. Power up camera and waiting for the indicator light of camera quick flash blue

Notification

1. Set Wi-Fi connection via mobile phone web browser require the camera is inactivated.
 2. Power up camera by power adapter rather than by PoE cable.
-

How to Set Wi-Fi Connection of Wi-Fi Camera via Mobile Phone Web Browser

1. Connect mobile phone to access point of Wi-Fi camera

- 1) Enable the WLAN of mobile phone.
- 2) Select the HAP_XXXXXX from the Wi-Fi list. Each camera has a unique access point SSID HAP_XXXXXX, XXXXXX stands for the verification code or the SN, which you can find on the device label.
- 3) Enter access point password, **password is depend on the SSID name**, if the SSID is HAP+ verification code, then the password is the last 8 characters of serial number on the label, for example, if the device serial number is D12345678, then the access point password is 12345678. If the SSID is HAP+ SN, then the access point password is AP+ verification code on the label, for example, if the verification code is ZFZFAJ, then the access point password is APZFZFAJ.

Title:	How to Set Wi-Fi Connection of Wi-Fi Camera via Mobile Phone Web Browser	Version:	V3.0	Date:	29/05/2023
Product:	Wi-Fi Camera			Page:	2 of 5

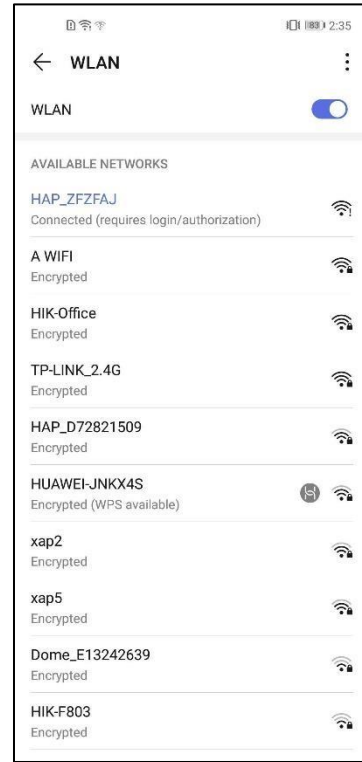
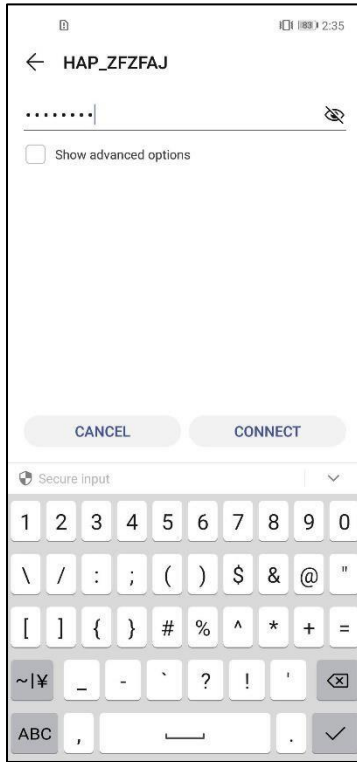
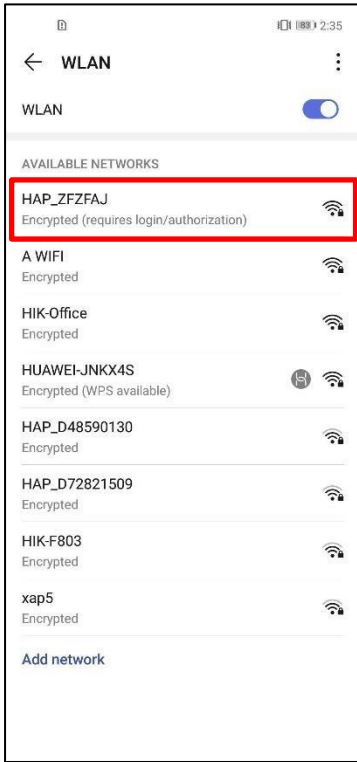

Title:	How to Set Wi-Fi Connection of Wi-Fi Camera via Mobile Phone Web Browser	Version:	V3.0	Date:	29/05/2023
Product:	Wi-Fi Camera			Page:	3 of 5



Verification Code and Serial Number on the label

2. Set Wi-Fi camera connect to Wi-Fi router

The browser on mobile phone will automatically open after the mobile phone is connected to access point of camera, if not, you can manually open the browser on mobile phone, tap  (**Refresh**), select the Wi-Fi that the camera needs to connect to, and enter password. The indicator light of camera slow flashing blue means Wi-Fi connected.

Title:	How to Set Wi-Fi Connection of Wi-Fi Camera via Mobile Phone Web Browser	Version:	V3.0	Date:	29/05/2023
Product:	Wi-Fi Camera			Page:	4 of 5

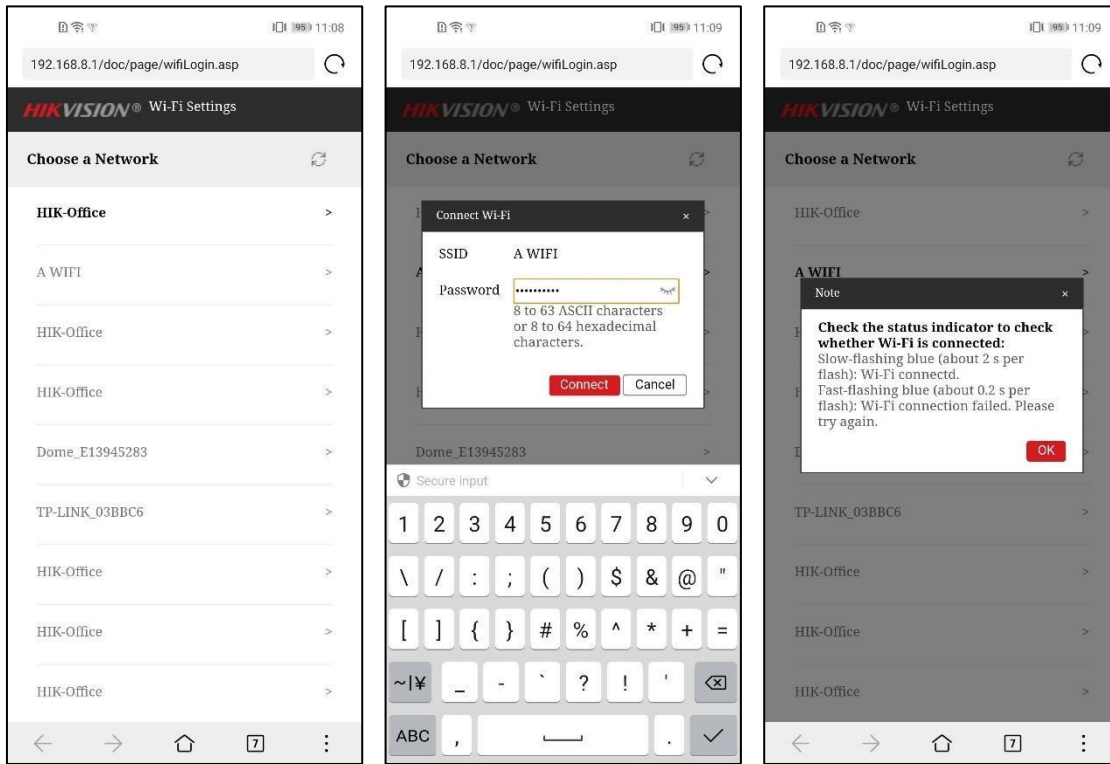

3. Connect camera to NVR

Connect NVR to the same network segment with camera, active camera and add it to NVR, then you can preview and record camera on NVR.



Title:	How to Set Wi-Fi Connection of Wi-Fi Camera via Mobile Phone Web Browser	Version:	V3.0	Date:	29/05/2023
Product:	Wi-Fi Camera			Page:	5 of 5

See Far, Go Further
HIKVISION Technical Support