

How to Add camera to NVR with RTSP Protocol

When camera is added to multiple NVRs through Hikvision protocol or Onvif protocol, NVRs would sync camera time, if the multiple NVRs are running with different time, camera time would switch frequently.

In this situation, customer can add camera by RTSP protocol to avoid it:

Note:

When camera added by RTSP protocol: Only support Live view, Record, Playback function, it does not support PTZ control, Modify Parameter, Configure OSD information and etc.

Step1, Protocol Management: Go to IP Channel>More> Protocol> Edit Protocol Name as RTSP, Type as RTSP , input the RTSP streaming path ,click OK.

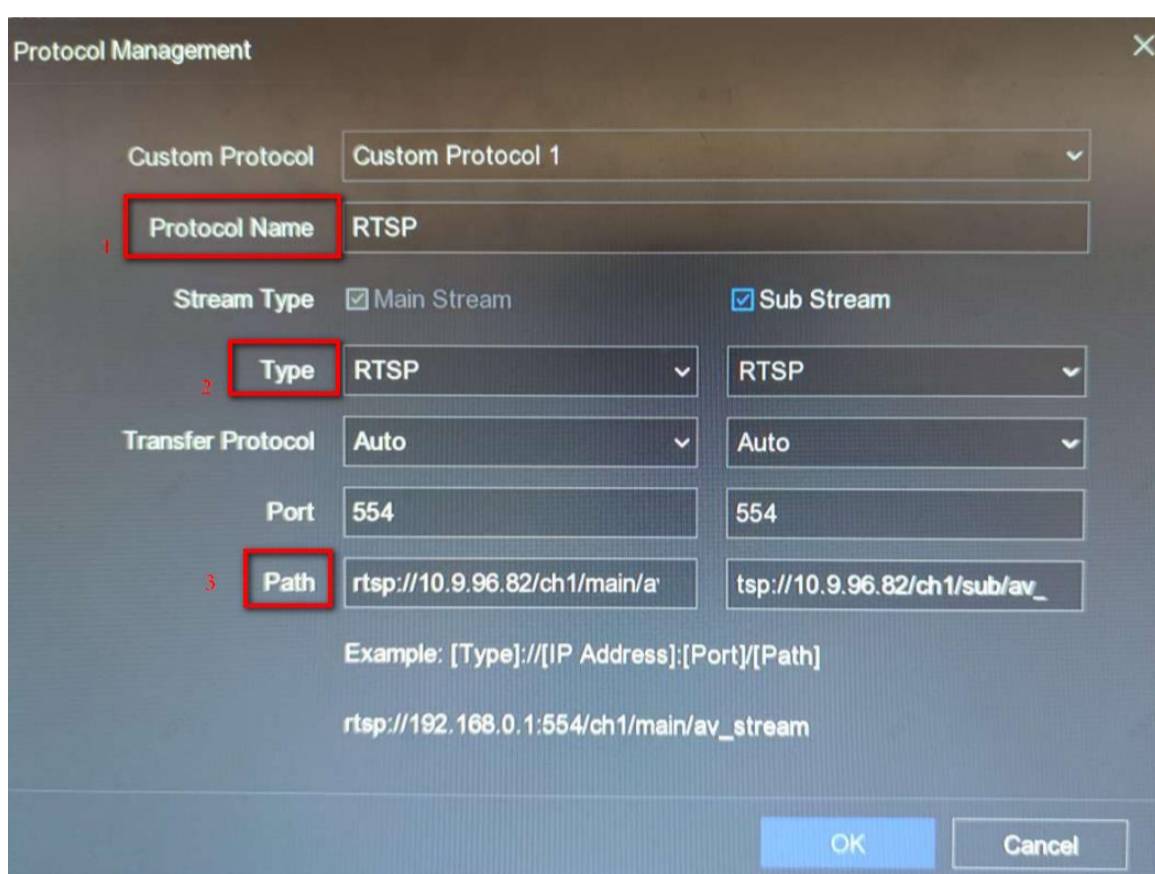

How to check if the RTSP streaming path could get stream :

- a) Open VLC player> right click and choose Open Media> Open network
- b) Input the RTSP streaming path and click **Play**. If the streaming path is correct, you can input device username and password to continue.

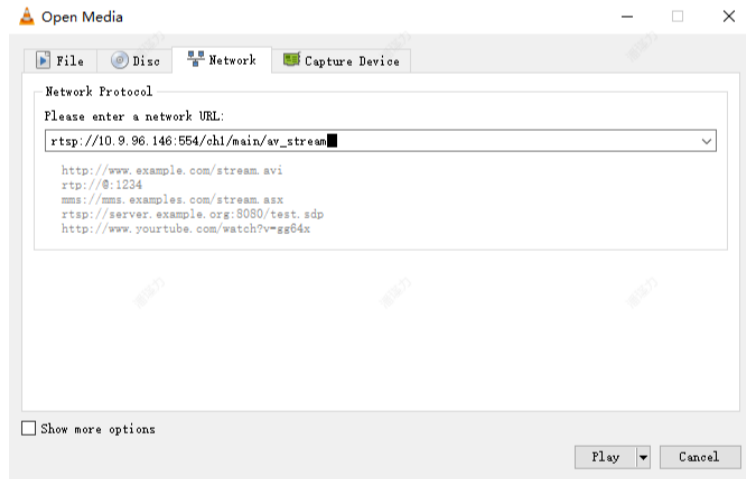
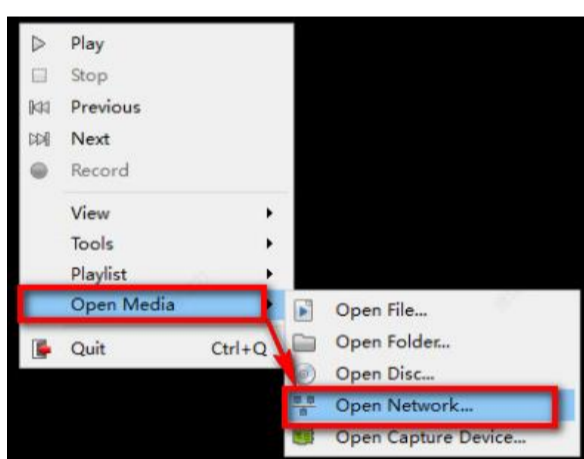

Step2, Add camera with RTSP protocol : Click Custom Add> Choose the IP address on device list or input IP address manually > Select Protocol as RTSP > input camera User Name and Password ,click Add.

