

Thermal Network Bullet Camera

Version:V5.5.2 build180528

Release Note

(2018-07-26 **External**)

General Information

Firmware Version	V5.5.2 build 180528
SDK Version	V5.3.5.30_build20180320
Play Lib	V7.3.5.31 build20180130
iVMS-4200	V2.6.8.6 build20180409
Web Component/Plugin Version	V4.0.1 build 180403/V3.0.6.40

V5.5.2 Key Updates

- 1、 Add the anti-burn function, when the algorithm detect direct sun light, DSP will upload the alarm information. If the device is moving, it will continue to move. If the device is still, it will move 2 current horizontal field of view of thermal lens toward the left direction. At the same time, it will display OSD hint. And move back to the former position 5 minutes later.
- 2、 Support check information in one key when the port is closed, make issue confirming and troubleshooting faster.

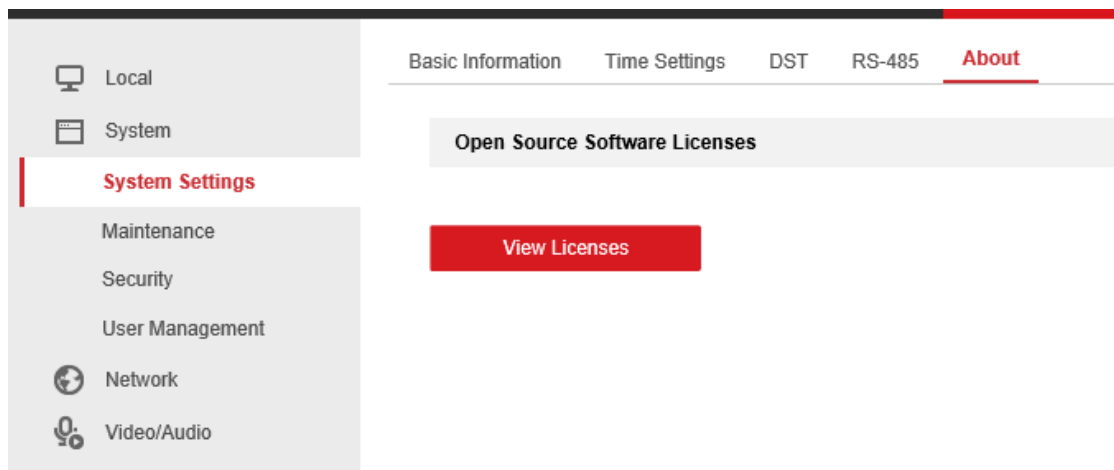

Picture1

- 3、 Add Manual tracking function in VCA. After enable auto tracking, click the Start Manual Tracking button to enable it, then after clicking or dragging some object, the device will track it, and the time can be adjusted. Optimize the effect of tracking at the same time to ensure the image is more stable when tracking.

PTZ

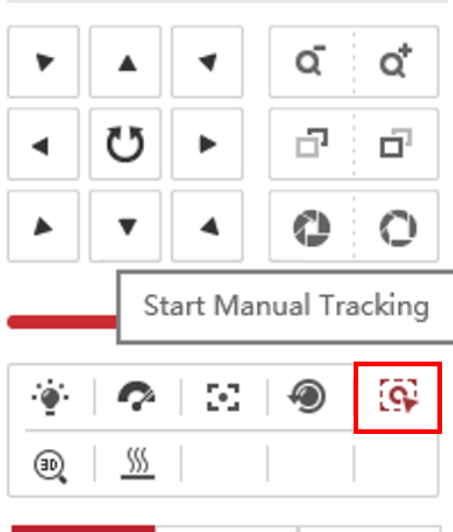

picture 2



picture 3

4、Add subsidiary focus function, the device can focus clearly by one click, but it only works when the optical/thermal channel is in semi-auto mode.

PTZ

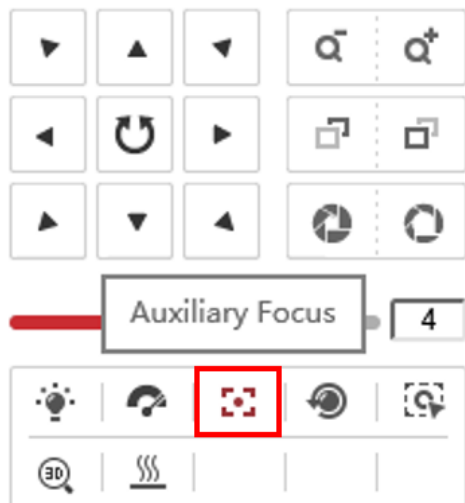

^ Focus

Focus Mode

Min. Focus Distance

- Update Dynamic Fire Source Detection relative functions. Add four Application Scene modes: including Forest-Fire Prevention, Straw Burning, High-building, Indoor/Perimeter. Add option for entering Installation height, all the modes can set this height value(1-500m) except Forest-Fire Prevention. Add cancel repetitive alarm option, the camera will alarm only once for the same alarm source in 24 hours after checking it.

Audio Exception Detection **Dynamic Fire Source Detection** Fire Source Region Shield

Channel No.

Basic Parameter Application Scene

Installation Height m

- The start time of speed dome and stable PTZ camera has been optimized,

cancelling electronic compass starting self-inspection.

- When upload information to ftp, it no longer upload it by event capture but upload picture pushed by ftp to ftp and save it to local. Dual-lens device will upload one optical picture and one thermal picture, and single-lens device will upload one thermal picture. The intelligent information including Temperature Measurement, Dynamic Fire Source Detection and VCA.
- Both optical and thermal channel have add the Min. Focus Distance, and it can reduce the focus time.

Image Adjustment

Exposure Settings

Focus

Focus Mode

Auto

Min. Focus Distance

10cm
50cm
1.0m
1.5m
3.0m
6.0m
10.0m
20.0m

Day/Night Switch

Backlight Settings

White Balance

Image Adjustment

Focus

Focus Mode

Auto

Min. Focus Distance

2.0m
5.0m
10.0m
30.0m

Focus Speed

Image Enhancement

Video Adjustment

- Modify the Fire Source Region Shield to be transparent or translucent. If check the

Display Shield Area, the region will be translucent. If not, the region will be transparent and it will not influence the Region shield function.

10、 When building a new scene, after clicking the 'Save' button, the ratio of optical channel will be changed to let the field of view of two channel be same automatically.

11、 Cancel the fire point focus mode and Smart264 function.

12、 The Config. File only can be imported each other when devices are the same model and firmware version.

Supported Product List

DS-2TD4136-25/50	DS-2TD4136-25/50	DS-2TD6236-75C2L	DS-2TD6236-50H2L
DS-2TD6266-50H2L	DS-2TD6266-75/100C2L	DS-2TD6266T-50H2L	
DS-2TD8166-75C2F	DS-2TD8166-100C2F	DS-2TD8166-150ZE2F	DS-2TD8166-180ZE2F
DS-2TD8135-100D2F	DS-2TD8135-100D2F	DS-2TD8135-100ZD2F	DS-2TD8135-100ZD2FL
DS-2TD8166-100D2F	DS-2TD8166-100ZD2F	DS-2TD8135-150ZD2F	DS-2TD8166-150D2F
DS-2TD8166-150ZD2F	DS-2TD8135-100D2FL		

Compatibility List



First Choice for Security Professionals

Test equipment	iVMS-4200	I series NVR	IE explorer
Version	v2.5.13.4 build20170801	DS-8608N-I8 V3.4.91_build161220	IE8+
Live view(display VCA info)	√	√(Web,4200)	√
Live view(display Fire point info)	√	√(Web,4200)	√
Live view(display Temperature info)	√	√(Web,4200)	√
Remote setup VCA rules (Line Crossing,Intrusion,Region Entrance,Region Exiting)	√	√(Web)	√
Setup Dynamic Fire Detection	√	√(4200, only support linkage)	√
Setup Temperature Measurement	√	√(4200, only support linkage)	√
Receive VCA Alarm info	√	√(4200)	×
Receive Dynamic Fire Detection info	√	√(4200)	×
Receive Temperature info	√	√(4200)	×
Playback(display VCA info)	√	√(Web,4200)	√
Playback(display Fire point info)	√	√(Web,4200)	√
Playback(display Temperature info)	√	√(Web,4200)	√