



HIKVISION EUROPE B.V.

How to Configure Contact List of the 2nd Generation VIS

Product: DS-KD8003-IME1, DS-KH8350-WTE1
Publisher: Dengyanan
Version: V.R20190705
File: IVMS-4200 3.1.0.7



Hikvision Europe B.V.

www.hikvision.com/europe

product.eu@hikvision.com

Purpose

Provide a guidance for contact list configuration

Preparation

Upgrade DS-KD8003-IME1 to 190604

Upgrade DS-KD-DIS to 190520

Steps

1. Add device and create group

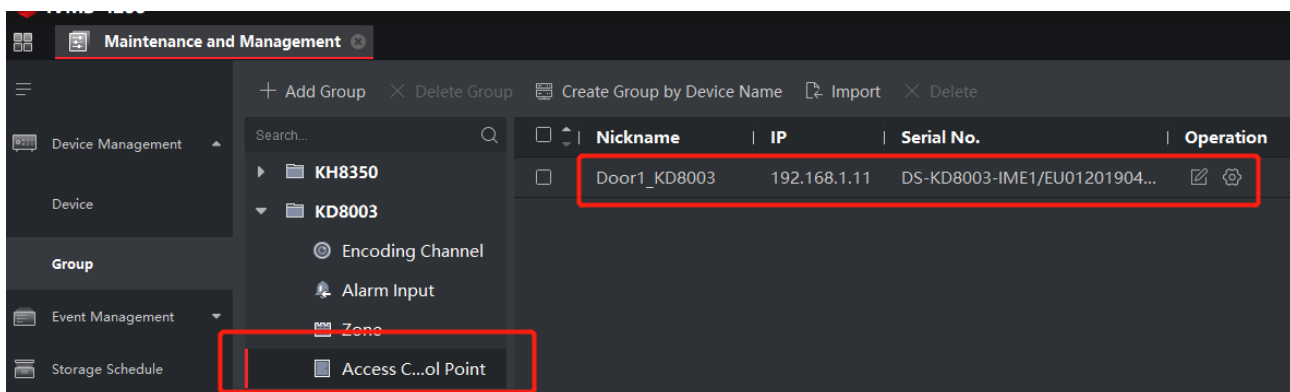
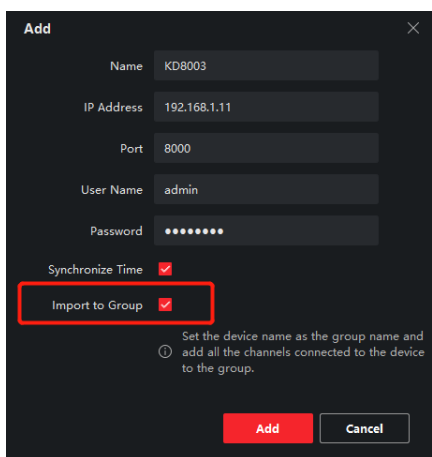

2. Check room number of indoor station

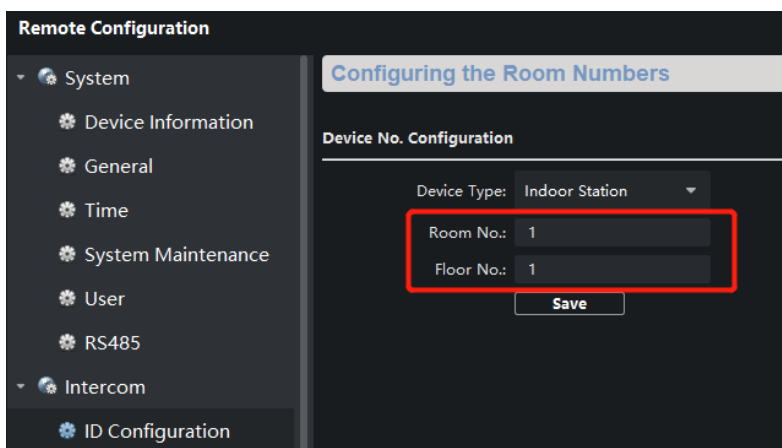

3. Add person, enter room number in <Resident Information>. One room number can be linked to multiple persons.

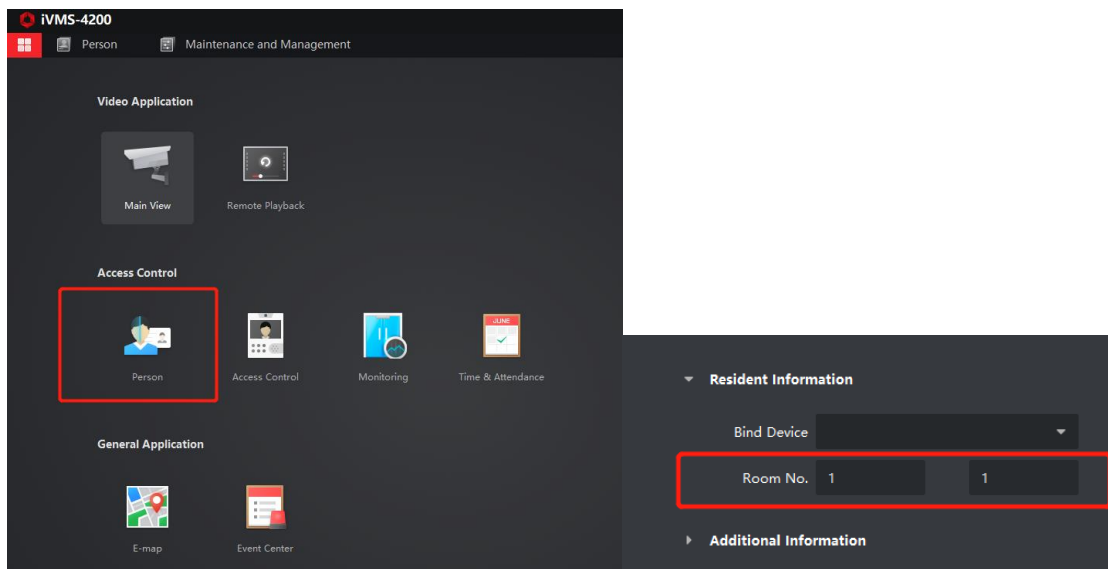

4. Go to <Access Controls>, add Access Group to link person with door.

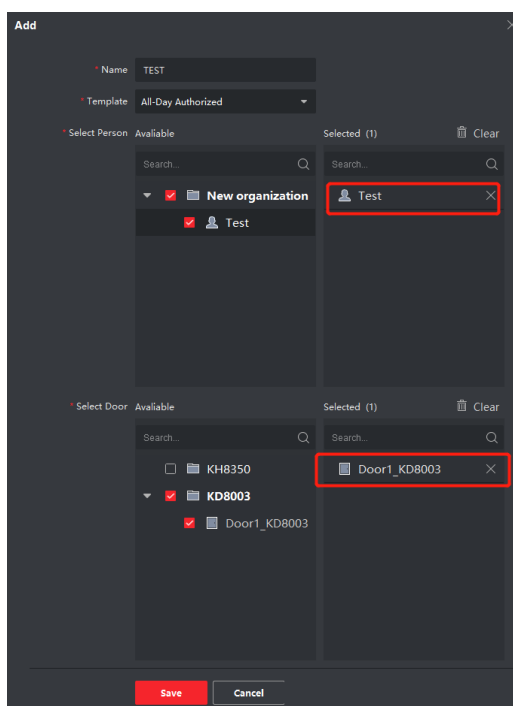
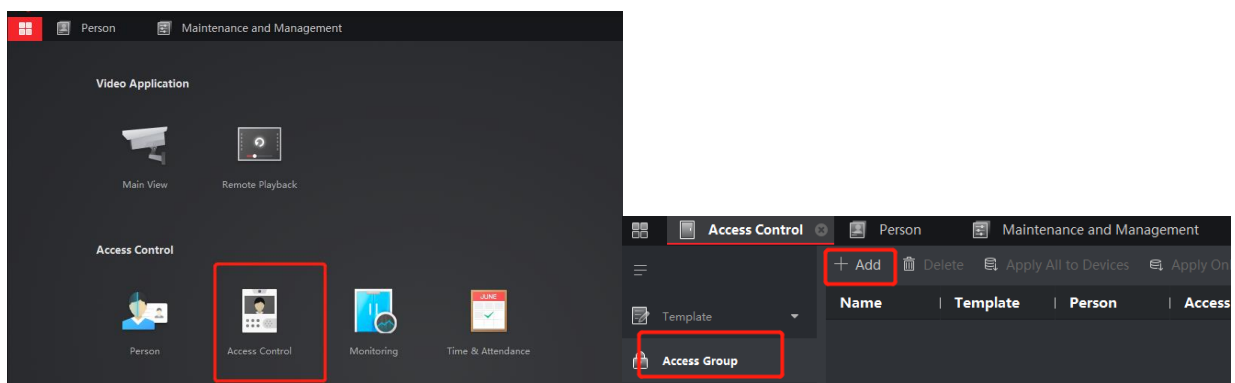

5. Apply to device

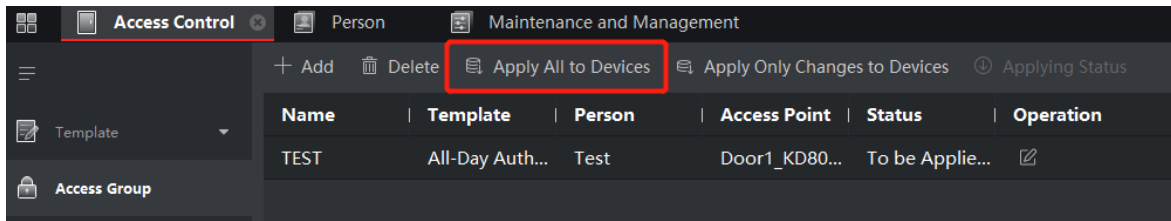

6. On display module, we can see "Importing".

