

Android Indoor Station Firmware Release Note

V2.1.84_build230407 (2023-06-14)

1. Firmware Basic Information

Firmware Basic Information	Firmware Version	V2.1.80_build230407
	Device Model	DS-KH9310-WTE1(B) DS-KH9510-WTE1(B)

Notes:

Please update firmware to the latest version to ensure the better user experience

Reason of Upgrade

Fix bugs, enhance products quality and meet customers' requirements.

Modified Features

1. Fixed known security vulnerabilities

For details, please refer:

<https://www.hikvision.com/en/support/cybersecurity/security-advisory/security-vulnerability-in-some-hikvision-access-control-intercom/>

Android Indoor Station Firmware Release Note

V2.1.80_build230320 (2023-04-14)

2. Firmware Basic Information

Firmware Basic Information	Firmware Version	V2.1.80_build230320
	Device Model	DS-KH9310-WTE1(B) DS-KH9510-WTE1(B)

Notes:

Please update firmware to the latest version to ensure the better user experience

New Feature:

1. Support 16 indoor extensions.
2. Support 5 apps maximum (was 2 in previous version), total storage ≤ 1 GB, RAM ≤ 500 MB, CPU ≤ 30%

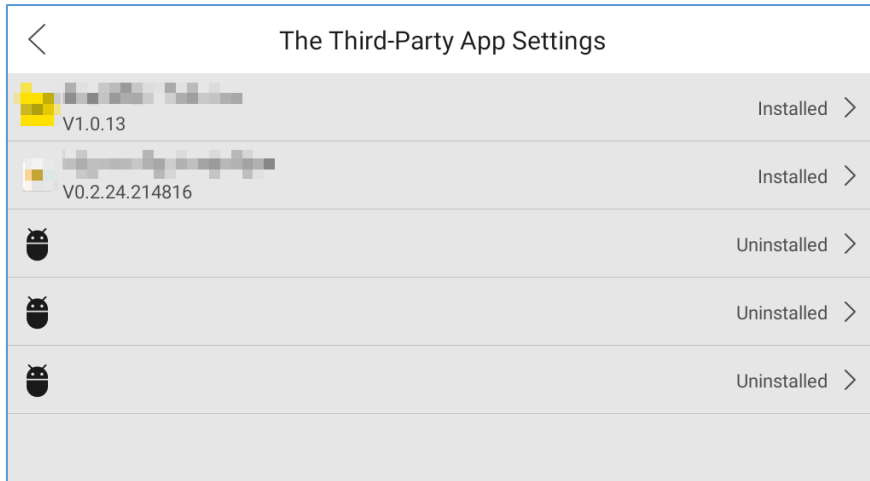

3. Support installing 3rd APP via TF card, copy apk file to TF card, and select from indoor station and install.

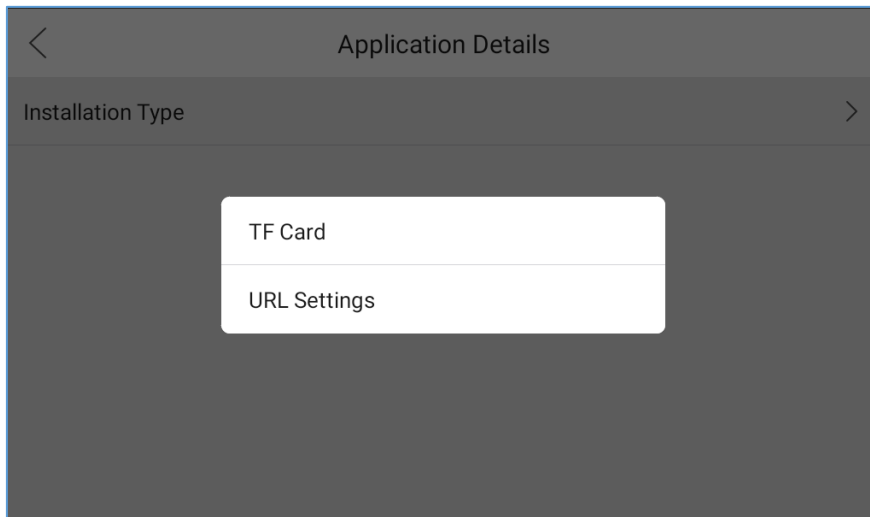

4. Support 34 languages:

English	Polski	Hrvatski	Українська	Svenska	
Français	Português	Čeština	Ελληνικά	Suomi	
Español	Русский	Nederlands	Norsk	Slovenščina	
Deutsch	Türkçe	Magyar	Dansk	繁體中文	Lietuvių
Italiano	Tiếng Việt	Srpski	Eesti	עברית	Português (Brasileiro)
العربية	Български	Română	Slovenčina	Latviešu	Монгол хэл

Modified Feature:

1. Update internal Hik-Connect version, when live view camera resolution is higher than 1080P H.264, then it will switch to sub stream automatically. (limited by hardware decoding performance)

Android Indoor Station Firmware Release Note**V2.1.76_build230204 (2023-02-24)****3. Firmware Basic Information**

Firmware Basic Information	Firmware Version	V2.1.76_build230204
	Device Model	DS-KH9310-WTE1(B) DS-KH9510-WTE1(B)

Notes:

Please update firmware to the latest version to ensure the better user experience

Modified Feature:

1. Optimize Wi-Fi function and device will scan every 30s in the background when the screen is off.

Android Indoor Station Firmware Release Note**V2.1.74_build221110 (2022-11-21)****1. Firmware Basic Information**

Firmware Basic Information	Firmware Version	V2.1.74_build221110
	Device Model	DS-KH9310-WTE1(B) DS-KH9510-WTE1(B)

Notes:

Please update firmware to the latest version to ensure the better user experience

New Feature:

1. Indoor extension also supports internal Hik-Connect App.

Note:

- A. currently the HC login status can not be synchronized from indoor station to extension, you have to login manually on extension device.
- B. Internal Hik-Connect is a special version and will not display intercom devices in the list

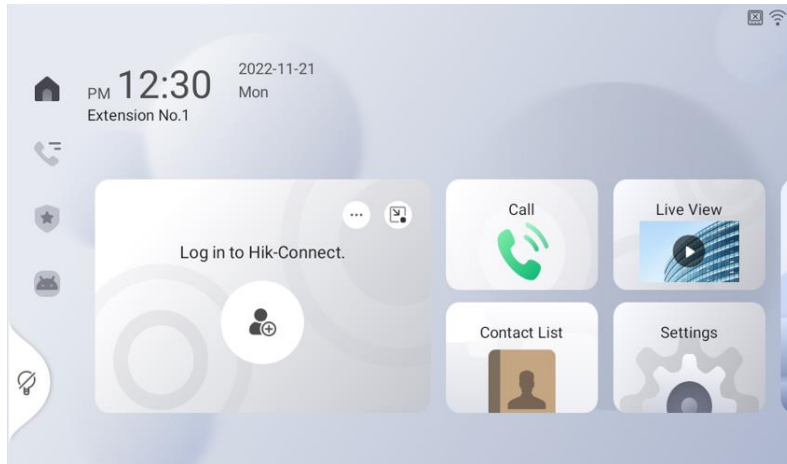

2. Add new function in wizard to check whether the activation password of the door and indoor station are the same, if not, it will prompt to enter the door station password in a separate pop-up box.

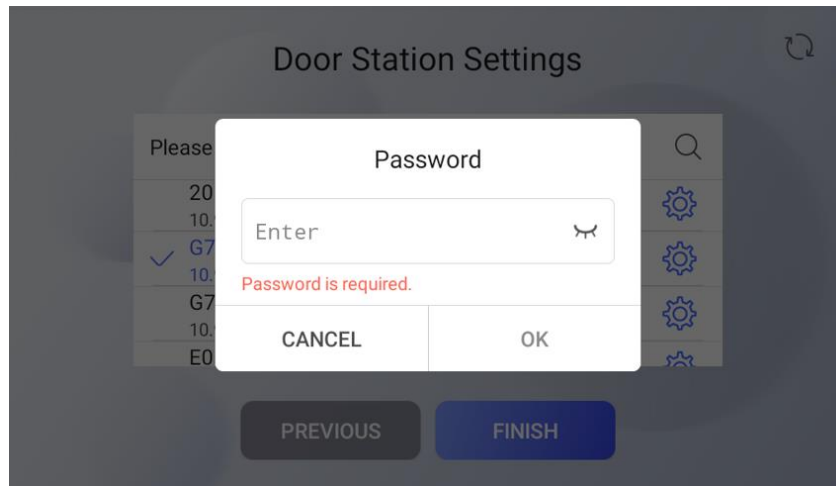

Modified Feature:

- 1. Change the gradient background at the top of the preview screen to transparent

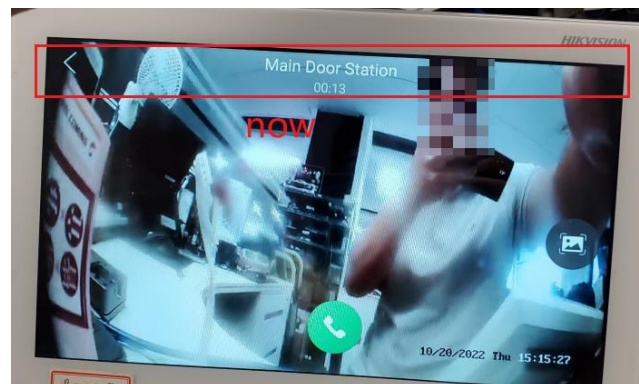
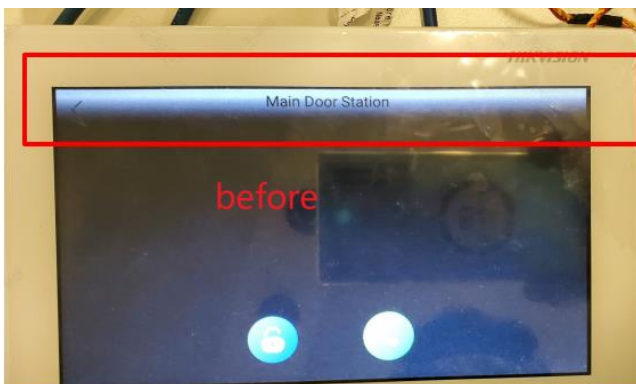

Android Indoor Station
Version: V2.1.48_build220620
Release Note
(2022-08-02)

1. Firmware Basic Information

Firmware Basic Information	Firmware Version	V2.1.48_build220620
	Device Type	DS-KH9310-WTE1(B) DS-KH9510-WTE1(B)

Notes:

Please update firmware to the latest version to ensure the perfect user experience

New:

3. Adds the function of sending captured images to Hik-Connect. When receiving a call from door station, the door station will capture an image and the image will be sent to Hik-Connect.

Fix:

1. Extends the limited third-party resource. (Memory 500 M CPU 30% flush 1G)
2. Displays custom device name on the live view list and the corresponding live view website page.

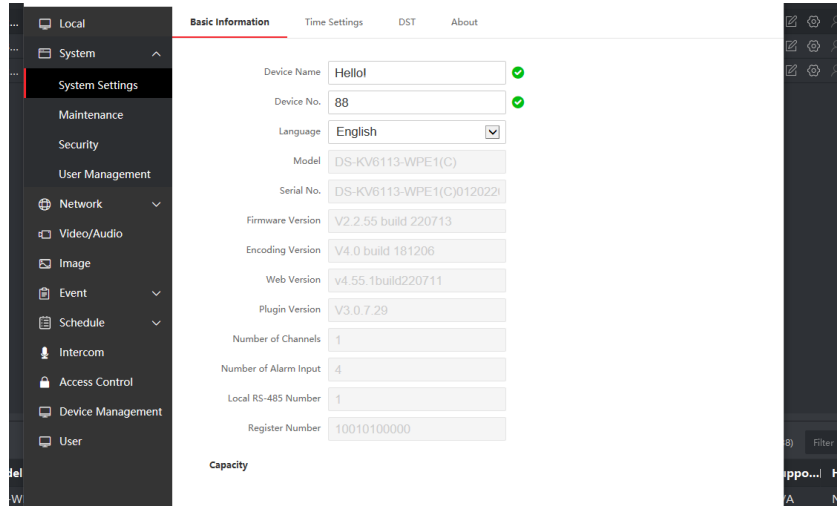

Live View

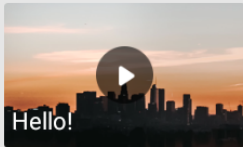

3. Deletes the installation package automatically when the APK file is installed.

Android Indoor Station

Version: V2.1.30_build220402

Release Note

(2022-04-02)

1. Firmware Basic Information

Firmware	Firmware Version	V2.1.30_build220402
----------	------------------	---------------------

Basic Information	Device Type	DS-KH9310-WTE1(B) DS-KH9510-WTE1(B)
--------------------------	-------------	--

Notes:

Please update firmware to the latest version to ensure the perfect user experience

1.1 Recommended Firmware

It is recommended to use the following devices and version together, because they can cooperate and work normally after the docking test.

Test resource	Device type	Version
Door Station	KD9403	V2.2.37_210929
	KD8003	V2.2.52_211126
	KV6113	V2.2.53_211104
	KB8113	V2.2.51_211110
Indoor Station	DS-KH9310	V2.1.30_build20220402
Main Station	KM9503	V1.0.32_build210926

Notes:

Test records only contain the cases for normally devices and do not represent all the scenarios and all the functions.

1.2 Compatibility

(1) This firmware version is use to update below models:

- DS-KH9310-WTE1(B)
- DS-KH9510-WTE1(B)

And this firmware CAN'T be updated to below models:

- DS-KH9310-WTE1
- DS-KH9510-WTE1

(2) For master-extension connections, below models with latest FW are recommended:

- DS-KH9310-WTE1/(B)
- DS-KH9510-WTE1/(B)
- DS-KH8350-WTE1/TE1
- DS-KH8520-WTE1
- DS-KH6320-WTE2/(B)
- DS-KH6320-LE1(B)

Following devices with Protocol 1.0 are not compatible with above models.

- DS-KH6320-LE1
- DS-KH6220-LE1

2. V2.1.30_build220402 Upgrade Note

2.1 Added Function:

1) Support reset admin password via email or security questions.

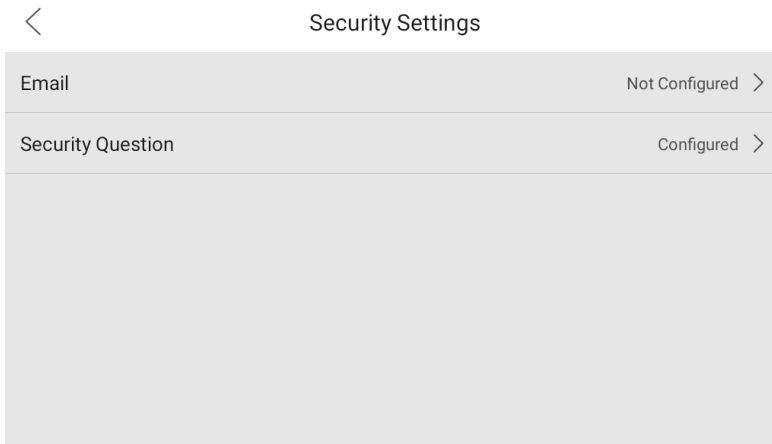

2) Support unlock via gesture.

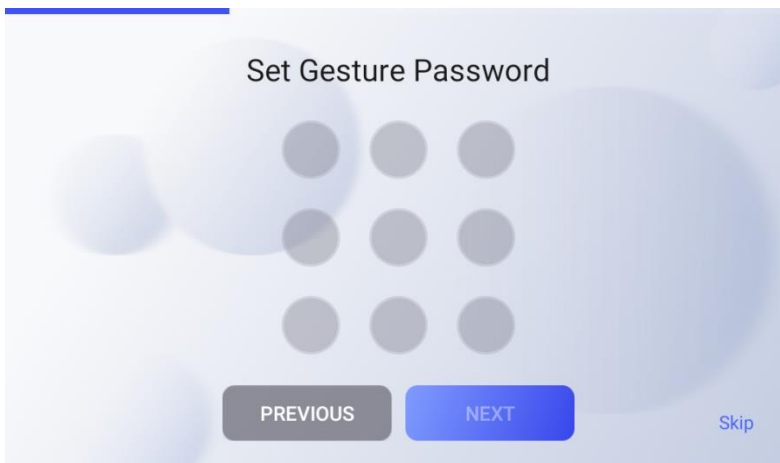

3) Support captured image, message auto-deletion function.

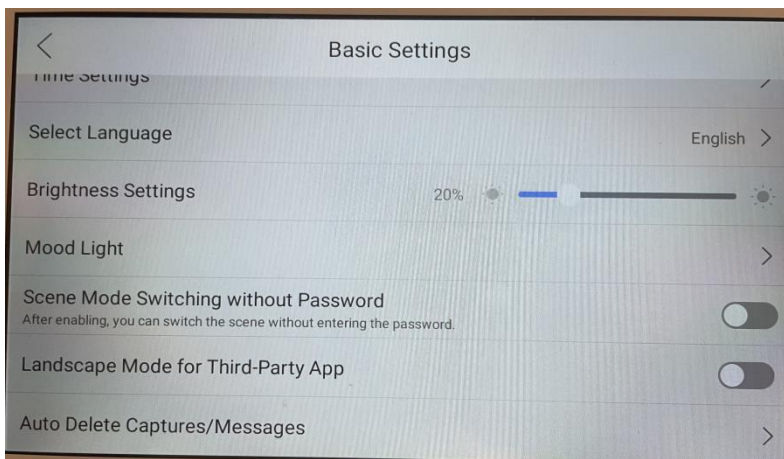

4) Support switch to the IPC live view page during 2-way audio.

2.2 Feature Optimization:

1) Support unicast and multicast options for video stream.

For multicast mode, the new version is supported up to 15 channels of video stream, but the switch or router must support the multicast mode at the same time, otherwise it can only support 6 channels of video stream.

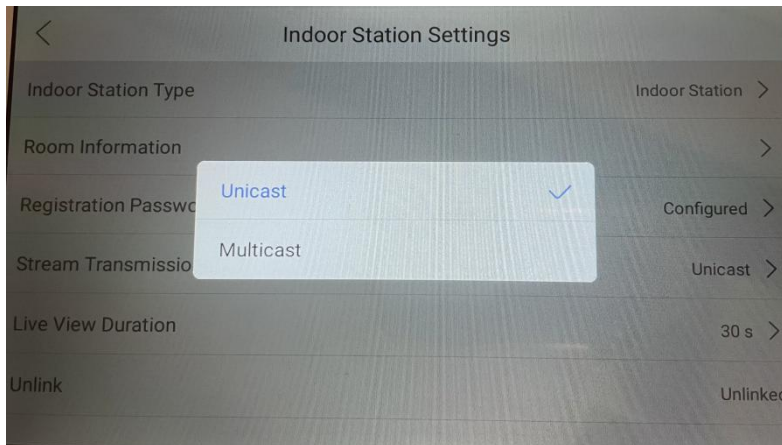

2) 22 languages are supported

English, French, Portuguese (Brazil), Spanish, Russian, German, Italian, Polish, Arabic, Turkish, Vietnamese, Hungarian, Dutch, Romanian, Czech, Bulgarian, Ukrainian, Croatian, Serbian, Greek, Norwegian, Danish

3) UI new style and optimization

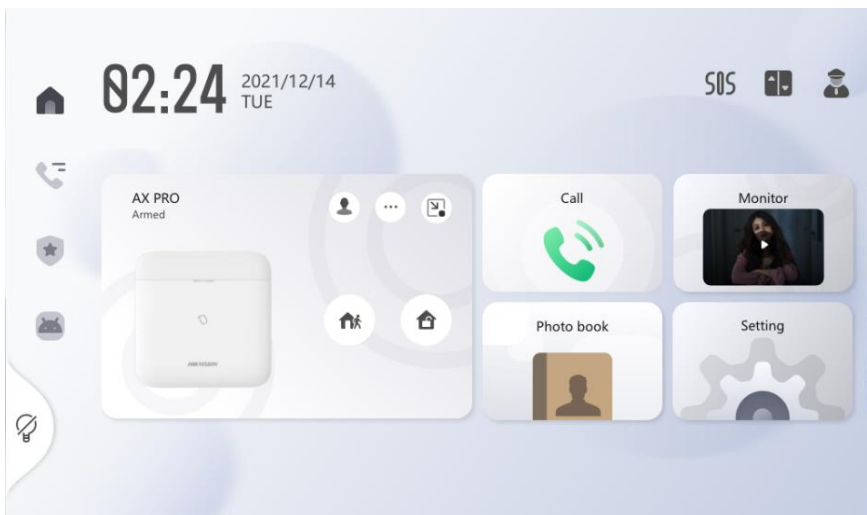

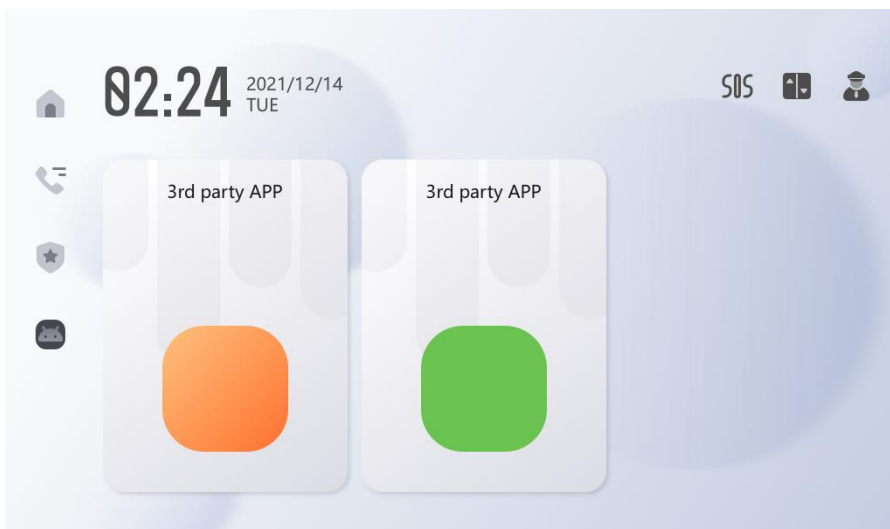
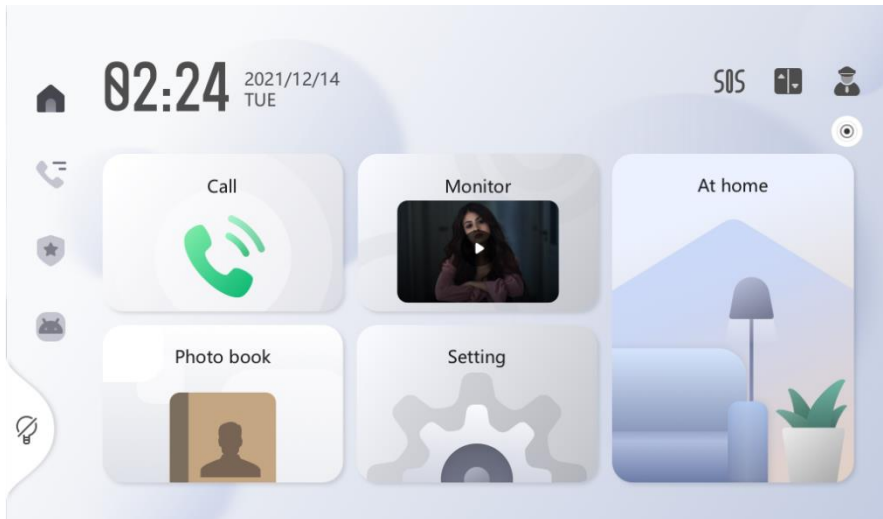

3. Notice

We strongly recommend updating the door stations to latest baseline firmware before working with this Android indoor station.

Remarks:

- Hikvision reserves the right to change, alter or withdraw the above notification without prior notice.
- Product design and specifications are subject to change without prior notice.

- The Hikvision firmware may contain errors known as errata which may cause the product to deviate from published specifications. Current characterized errata are available on request.
- Hikvision is not liable for any typing or printing errors.

Hikvision Digital Technology CO., Ltd.
No. 555 Qianmo Road, Binjiang District, Hangzhou 310051,
China
Tel: +86-571-8807-5998
FAX: +86-571-8993-5635
Email: overseabusiness@hikvision.com