

## Network Camera Firmware Version: V5.7.10

### Release Note

(2022-07-20)

<b>Firmware Basic Information</b>	Firmware Version: V5.7.10 build220720
-----------------------------------	---------------------------------------

## 2xx3G2, 2xx6G2, 2xx7G2, 3xx3G2, 3xx6G2, 3xx7G2 Camera V5.7.10 Features

### 1. New Features

- Added support HPC features;
  1. ISAPI uplink supports device exception and alarm event uploading. ISAPI uplink Event includes: Motion Detection, Intrusion Detection, Line Crossing Detection. Linkage supports recording and capture.
  2. Added capability set to support ISAPI uplink events
  3. ISAPI downlink, mainly used for device configuration
  4. Support device auto upgrade on ProConnect Portal and App
- Added Korean and Hebrew to the OSD function for overseas products;

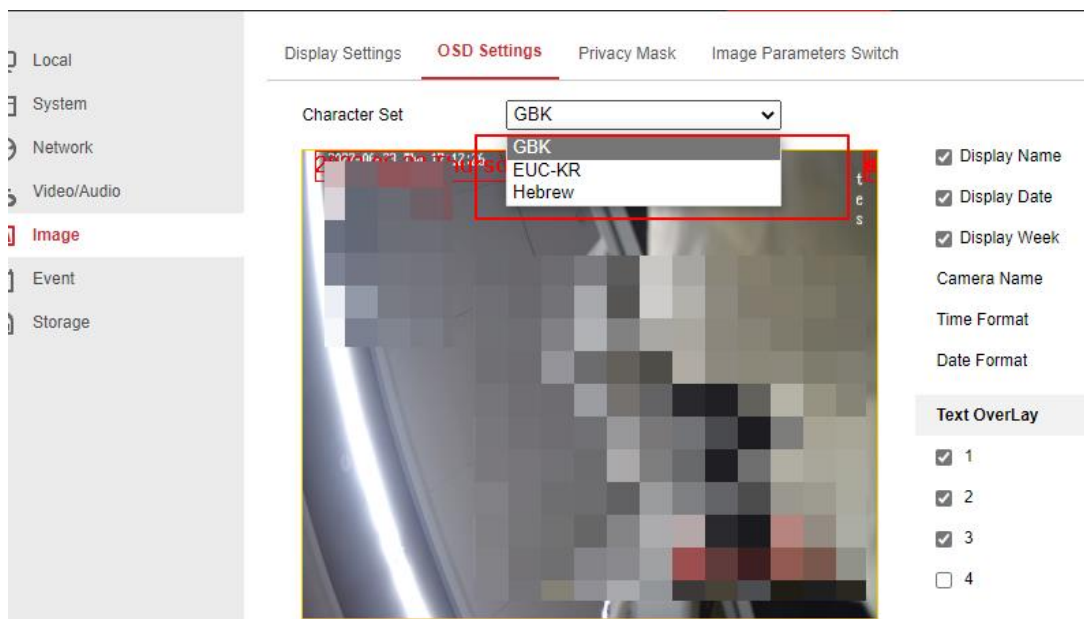

- Support modify SSH port.

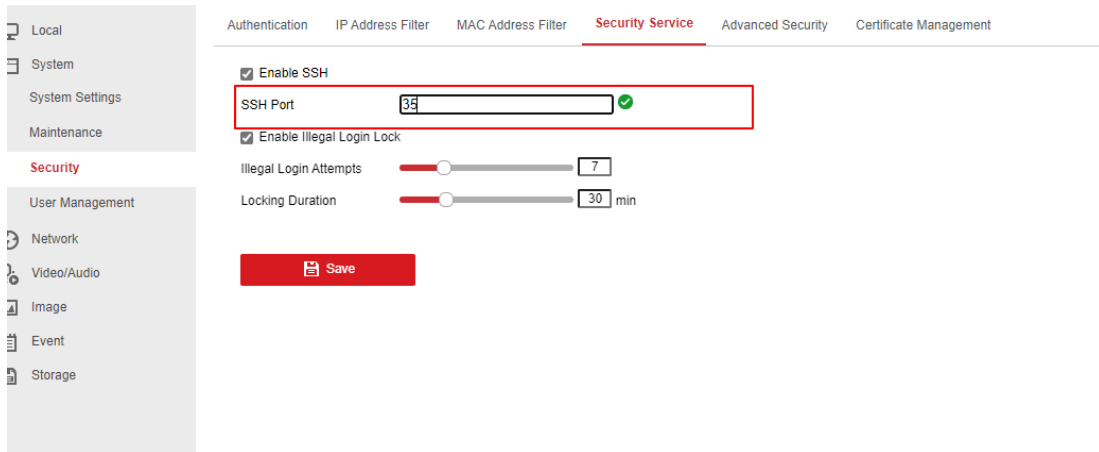

- ColorVu products support perimeter intelligent linkage supplement light.
- Support HC APP to configure one-click audible and visual alarm and audible and visual arming plan.
- Added support perimeter metadata for overseas 2 and 3 series product.
- Support SFTP, SRTP and defog function for overseas 3 series product.

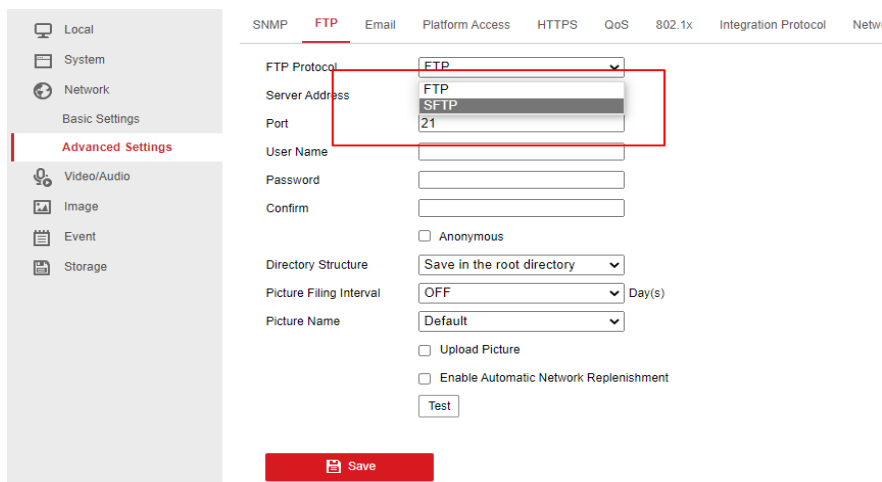
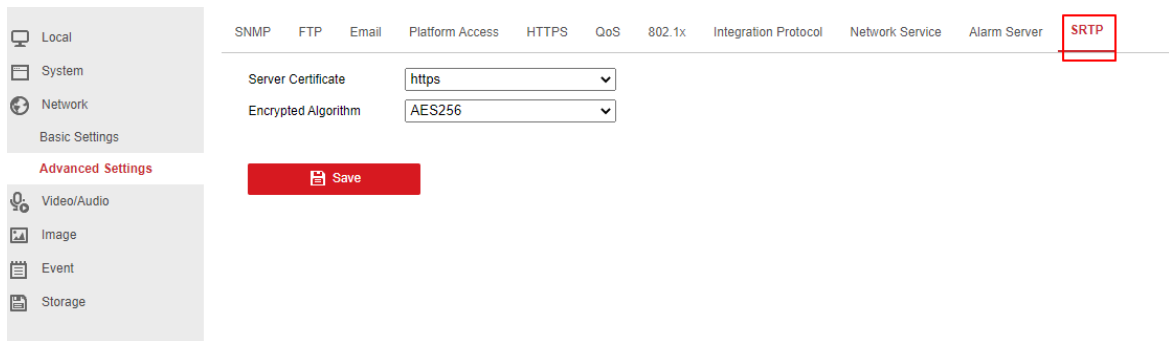

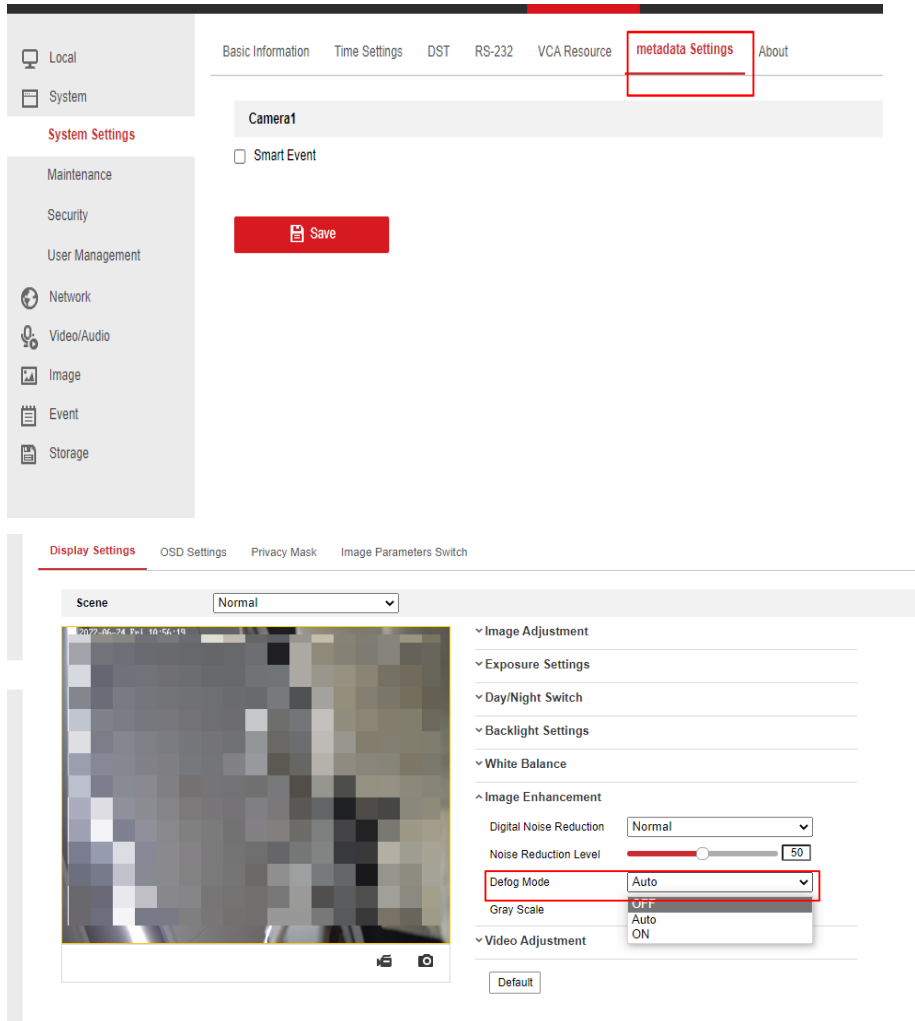

- Added support Flashing Alarm and White Light in the Linkage Method

Supplement light brightness strategy is when the light is turn off, the light will turn on with a brightness value of 50 after the alarm is triggered; when the light is turn on, the brightness of the supplement light will increase by 50 after the alarm is triggered, and the maximum can be adjusted to 100.

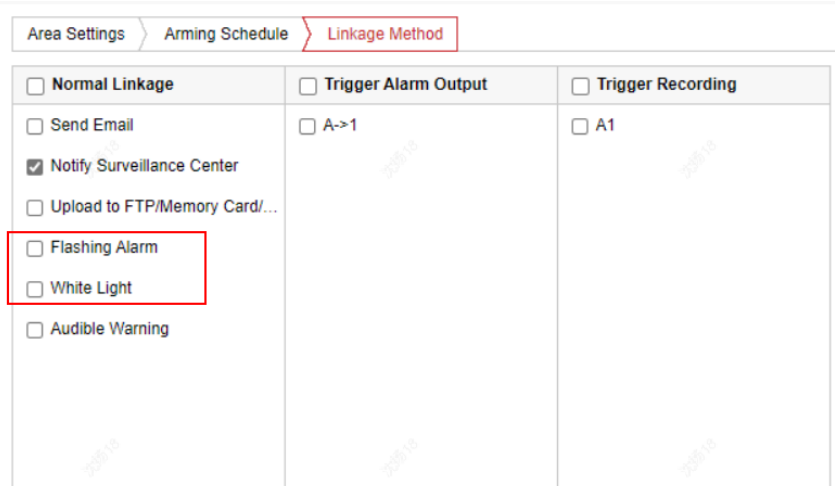

## Customer Impact and Recommended Action

This update refers to function/compatibility improvement and will take effect automatically after the Date of Change. We are very sorry for any inconvenience of use-habit changes caused by this action. For any questions and request for this firmware, please contact our local technical support team.

### Remarks:

- Hikvision reserves the right to change, alter or withdraw the above notification without prior notice.
- Product design and specifications are subject to change without prior notice.
- The Hikvision firmware may contain errors known as errata which may cause the product to deviate from published specifications. Current characterized errata are available on request.
- Hikvision is not liable for any typing or printing errors.

Hikvision Digital Technology CO., Ltd.

No. 555 Qianmo Road, Binjiang District, Hangzhou  
310051, China

Tel: +86-571-8807-5998

### **Supported Product List (1x83G0, 2xx3G2, 2xx6G2(C), 2xx7G2(C), 3xx3G2, 3xx6G2(C), 3xx7G2(C) Series)**

<b>Product Category</b>	<b>Model Number</b>
1 Series	DS-2CD1083G0-I(U)(F)
1 Series	DS-2CD1183G0-I(U)(F)
1 Series	DS-2CD1383G0-I(U)(F)
Pro 2 Series	DS-2CD2023G2-I(U)
Pro 2 Series	DS-2CD2043G2-I(U)
Pro 2 Series	DS-2CD2063G2-I(U)
Pro 2 Series	DS-2CD2083G2-I(U)
Pro 2 Series	DS-2CD2123G2-I(S)
Pro 2 Series	DS-2CD2123G2-IU
Pro 2 Series	DS-2CD2143G2-I(S)

Pro 2 Series	DS-2CD2143G2-IU
Pro 2 Series	DS-2CD2163G2-I(S)
Pro 2 Series	DS-2CD2163G2-IU
Pro 2 Series	DS-2CD2183G2-I(S)
Pro 2 Series	DS-2CD2183G2-IU
Pro 2 Series	DS-2CD2323G2-I(U)
Pro 2 Series	DS-2CD2343G2-I(U)
Pro 2 Series	DS-2CD2363G2-I(U)
Pro 2 Series	DS-2CD2383G2-I(U)
Pro 2 Series	DS-2CD2423G2-I(W)
Pro 2 Series	DS-2CD2443G2-I(W)
Pro 2 Series	DS-2CD2463G2-I
Pro 2 Series	DS-2CD2483G2-I
Pro 2 Series	DS-2CD2523G2-I(S)
Pro 2 Series	DS-2CD2543G2-I(W)
Pro 2 Series	DS-2CD2563G2-I(S)
Pro 2 Series	DS-2CD2583G2-I(S)
Pro 2 Series	DS-2CD2623G2-IZS
Pro 2 Series	DS-2CD2643G2-IZS
Pro 2 Series	DS-2CD2663G2-IZS
Pro 2 Series	DS-2CD2683G2-IZS
Pro 2 Series	DS-2CD2723G2-IZS
Pro 2 Series	DS-2CD2743G2-IZS
Pro 2 Series	DS-2CD2763G2-IZS
Pro 2 Series	DS-2CD2783G2-IZS
Pro 2 Series	DS-2CD2E23G2-U
Pro 2 Series	DS-2CD2E43G2-U

Pro 2 Series	DS-2CD2H23G2-IZS
Pro 2 Series	DS-2CD2H43G2-IZS
Pro 2 Series	DS-2CD2H63G2-IZS
Pro 2 Series	DS-2CD2H83G2-IZS
Pro 2 Series	DS-2CD2T23G2-2I/4I
Pro 2 Series	DS-2CD2T43G2-2I/4I
Pro 2 Series	DS-2CD2T63G2-2I/4I
Pro 2 Series	DS-2CD2T83G2-2I/4I
Pro/2 Series with AcuSense	DS-2CD2026G2-I(U)(C)
Pro/2 Series with AcuSense	DS-2CD2026G2-IU/SL(C)
Pro/2 Series with AcuSense	DS-2CD2046G2-I(U)(C)
Pro/2 Series with AcuSense	DS-2CD2046G2-IU/SL(C)
Pro/2 Series with AcuSense	DS-2CD2066G2-I(U)(C)
Pro/2 Series with AcuSense	DS-2CD2066G2-IU/SL(C)
Pro/2 Series with AcuSense	DS-2CD2086G2-IU/SL(C)
Pro/2 Series with AcuSense	DS-2CD2086G2-I(U)(C)
Pro/2 Series with AcuSense	DS-2CD2126G2-I(SU)(C)
Pro/2 Series with AcuSense	DS-2CD2146G2-I(SU)(C)
Pro/2 Series with AcuSense	DS-2CD2166G2-I(SU)(C)
Pro/2 Series with AcuSense	DS-2CD2186G2-I(SU)(C)
Pro/2 Series with AcuSense	DS-2CD2326G2-I(U)(C)
Pro/2 Series with AcuSense	DS-2CD2326G2-ISU/SL(C)
Pro/2 Series with AcuSense	DS-2CD2346G2-I(U)(C)
Pro/2 Series with AcuSense	DS-2CD2346G2-ISU/SL(C)
Pro/2 Series with AcuSense	DS-2CD2366G2-I(U)(C)
Pro/2 Series with AcuSense	DS-2CD2366G2-ISU/SL(C)
Pro/2 Series with AcuSense	DS-2CD2386G2-I(U)(C)

Pro/2 Series with AcuSense	DS-2CD2386G2-ISU/SL(C)
Pro/2 Series with AcuSense	DS-2CD2426G2-I(W)(C)
Pro/2 Series with AcuSense	DS-2CD2446G2-I(W)(C)
Pro/2 Series with AcuSense	DS-2CD2466G2-I(C)
Pro/2 Series with AcuSense	DS-2CD2526G2-I(S)(C)
Pro/2 Series with AcuSense	DS-2CD2546G2-I(WS)(C)
Pro/2 Series with AcuSense	DS-2CD2566G2-I(S)(C)
Pro/2 Series with AcuSense	DS-2CD2586G2-I(S)(C)
Pro/2 Series with AcuSense	DS-2CD2626G2-IZS(C)
Pro/2 Series with AcuSense	DS-2CD2626G2T-IZS(C)
Pro/2 Series with AcuSense	DS-2CD2626G2-IZSU/SL(C)
Pro/2 Series with AcuSense	DS-2CD2646G2-IZS(C)
Pro/2 Series with AcuSense	DS-2CD2646G2T-IZS(C)
Pro/2 Series with AcuSense	DS-2CD2646G2-IZSU/SL(C)
Pro/2 Series with AcuSense	DS-2CD2666G2-IZS(C)
Pro/2 Series with AcuSense	DS-2CD2666G2T-IZS(C)
Pro/2 Series with AcuSense	DS-2CD2666G2-IZSU/SL(C)
Pro/2 Series with AcuSense	DS-2CD2686G2-IZS(C)
Pro/2 Series with AcuSense	DS-2CD2686G2T-IZS(C)
Pro/2 Series with AcuSense	DS-2CD2686G2-IZSU/SL(C)
Pro/2 Series with AcuSense	DS-2CD2726G2-IZS(C)
Pro/2 Series with AcuSense	DS-2CD2726G2T-IZS(C)
Pro/2 Series with AcuSense	DS-2CD2746G2-IZS(C)
Pro/2 Series with AcuSense	DS-2CD2746G2T-IZS(C)
Pro/2 Series with AcuSense	DS-2CD2766G2-IZS(C)
Pro/2 Series with AcuSense	DS-2CD2766G2T-IZS(C)
Pro/2 Series with AcuSense	DS-2CD2786G2-IZS(C)

Pro/2 Series with AcuSense	DS-2CD2786G2T-IZS(C)
Pro/2 Series with AcuSense	DS-2CD2H26G2-IZS(C)
Pro/2 Series with AcuSense	DS-2CD2H26G2T-IZS(C)
Pro/2 Series with AcuSense	DS-2CD2H46G2-IZS(C)
Pro/2 Series with AcuSense	DS-2CD2H46G2T-IZS(C)
Pro/2 Series with AcuSense	DS-2CD2H66G2-IZS(C)
Pro/2 Series with AcuSense	DS-2CD2H66G2T-IZS(C)
Pro/2 Series with AcuSense	DS-2CD2H86G2-IZS(C)
Pro/2 Series with AcuSense	DS-2CD2H86G2T-IZS(C)
Pro/2 Series with AcuSense	DS-2CD2T26G2-2I/4I(C)
Pro/2 Series with AcuSense	DS-2CD2T26G2-ISU/SL(C)
Pro/2 Series with AcuSense	DS-2CD2T46G2-2I/4I(C)
Pro/2 Series with AcuSense	DS-2CD2T46G2-ISU/SL(C)
Pro/2 Series with AcuSense	DS-2CD2T66G2-2I/4I(C)
Pro/2 Series with AcuSense	DS-2CD2T66G2-ISU/SL(C)
Pro/2 Series with AcuSense	DS-2CD2T86G2-2/4I(C)
Pro/2 Series with AcuSense	DS-2CD2T86G2-ISU/SL(C)
Pro/2 Series with ColorVu	DS-2CD2027G2-L(U)(C)
Pro/2 Series with ColorVu	DS-2CD2047G2-L(U)(C)
Pro/2 Series with ColorVu	DS-2CD2047G2-LU/SL(C)
Pro/2 Series with ColorVu	DS-2CD2087G2-L(U)(C)
Pro/2 Series with ColorVu	DS-2CD2127G2(-SU)(C)
Pro/2 Series with ColorVu	DS-2CD2147G2(-SU)(C)
Pro/2 Series with ColorVu	DS-2CD2147G2-L(SU)
Pro/2 Series with ColorVu	DS-2CD2327G2-L(U)(C)
Pro/2 Series with ColorVu	DS-2CD2347G2-L(U)(C)
Pro/2 Series with ColorVu	DS-2CD2347G2-LSU/SL(C)



Pro/2 Series with ColorVu	DS-2CD2387G2-L(U)(C)
Pro/2 Series with ColorVu	DS-2CD2387G2-LSU/SL
Pro/2 Series with ColorVu	DS-2CD2527G2-LS(C)
Pro/2 Series with ColorVu	DS-2CD2547G2-LS(C)
Pro/2 Series with ColorVu	DS-2CD2647G2-LZS(C)
Pro/2 Series with ColorVu	DS-2CD2647G2T-LZS(C)
Pro/2 Series with ColorVu	DS-2CD2747G2-LZS(C)
Pro/2 Series with ColorVu	DS-2CD2747G2T-LZS (C)
Pro/2 Series with ColorVu	DS-2CD2T27G2-L(C)
Pro/2 Series with ColorVu	DS-2CD2T47G2-L(C)
Pro/2 Series with ColorVu	DS-2CD2T47G2-LSU/SL(C)
Pro/2 Series with ColorVu	DS-2CD2T87G2-L(C)
Pro/2 Series with ColorVu	DS-2CD2T87G2-LSU/SL
Pro 3 Series	DS-2CD3023G2-IU
Pro 3 Series	DS-2CD3043G2-IU
Pro 3 Series	DS-2CD3063G2-IU
Pro 3 Series	DS-2CD3123G2-I(S)U
Pro 3 Series	DS-2CD3143G2-I(S)U
Pro 3 Series	DS-2CD3163G2-I(S)U
Pro 3 Series	DS-2CD3323G2-IU
Pro 3 Series	DS-2CD3343G2-IU
Pro 3 Series	DS-2CD3363G2-IU
Pro 3 Series	DS-2CD3523G2-IS
Pro 3 Series	DS-2CD3543G2-IS
Pro 3 Series	DS-2CD3563G2-IS
Pro 3 Series	DS-2CD3623G2-IZS
Pro 3 Series	DS-2CD3643G2-IZS

Pro 3 Series	DS-2CD3663G2-IZS
Pro 3 Series	DS-2CD3723G2-IZS
Pro 3 Series	DS-2CD3743G2-IZS
Pro 3 Series	DS-2CD3763G2-IZS
Pro 3 Series	DS-2CD3T23G2-2I/4IS
Pro 3 Series	DS-2CD3T43G2-2I/4IS
Pro 3 Series	DS-2CD3T63G2-2I/4IS
Pro/3 Series with AcuSense	DS-2CD3026G2-IS(C)
Pro/3 Series with AcuSense	DS-2CD3026G2-IU/SL(C)
Pro/3 Series with AcuSense	DS-2CD3056G2-IS(C)
Pro/3 Series with AcuSense	DS-2CD3056G2-IU/SL(C)
Pro/3 Series with AcuSense	DS-2CD3086G2-IS(C)
Pro/3 Series with AcuSense	DS-2CD3126G2-IS(U)(C)
Pro/3 Series with AcuSense	DS-2CD3156G2-IS(U)(C)
Pro/3 Series with AcuSense	DS-2CD3186G2-IS(U)(C)
Pro/3 Series with AcuSense	DS-2CD3326G2-ISU(C)
Pro/3 Series with AcuSense	DS-2CD3326G2-ISU/SL(C)
Pro/3 Series with AcuSense	DS-2CD3356G2-ISU(C)
Pro/3 Series with AcuSense	DS-2CD3356G2-ISU/SL(C)
Pro/3 Series with AcuSense	DS-2CD3386G2-ISU(C)
Pro/3 Series with AcuSense	DS-2CD3526G2-IS (C)
Pro/3 Series with AcuSense	DS-2CD3556G2-IS (C)
Pro/3 Series with AcuSense	DS-2CD3586G2-IS (C)
Pro/3 Series with AcuSense	DS-2CD3626G2-IZS(C)
Pro/3 Series with AcuSense	DS-2CD3626G2T-IZS(C)
Pro/3 Series with AcuSense	DS-2CD3656G2-IZS(C)
Pro/3 Series with AcuSense	DS-2CD3656G2T-IZS(C)

Pro/3 Series with AcuSense	DS-2CD3656G2T-IZSY(2.7-13.5mm)(C)(O-STD)
Pro/3 Series with AcuSense	DS-2CD3686G2-IZS(C)
Pro/3 Series with AcuSense	DS-2CD3686G2T-IZS(C)
Pro/3 Series with AcuSense	DS-2CD3726G2T-IZS(C)
Pro/3 Series with AcuSense	DS-2CD3726G2T-IZS(C)
Pro/3 Series with AcuSense	DS-2CD3756G2-IZS(C)
Pro/3 Series with AcuSense	DS-2CD3756G2T-IZS(C)
Pro/3 Series with AcuSense	DS-2CD3756G2T-IZSY(2.7-13.5mm)(C)(O-STD)
Pro/3 Series with AcuSense	DS-2CD3786G2-IZS(C)
Pro/3 Series with AcuSense	DS-2CD3786G2T-IZS(C)
Pro/3 Series with AcuSense	DS-2CD3B26G2T-IZHS(Y)(C)
Pro/3 Series with AcuSense	DS-2CD3B46G2T-IZHS(Y)(C)
Pro/3 Series with AcuSense	DS-2CD3T56G2-4ISY (C)
Pro/3 Series with AcuSense	DS-2CD3B86G2T-IZHS(Y)(C)
Pro/3 Series with AcuSense	DS-2CD3D26G2-IZS(C)
Pro/3 Series with AcuSense	DS-2CD3D46G2-IZS(C)
Pro/3 Series with AcuSense	DS-2CD3D86G2-IZS(C)
Pro/3 Series with AcuSense	DS-2CD3H26G2-IZS(C)
Pro/3 Series with AcuSense	DS-2CD3H56G2-IZS(C)
Pro/3 Series with AcuSense	DS-2CD3H86G2-IZS(C)
Pro/3 Series with AcuSense	DS-2CD3T26G2-4IS(C)
Pro/3 Series with AcuSense	DS-2CD3T26G2-ISU/SL(C)
Pro/3 Series with AcuSense	DS-2CD3T56G2-4IS(C)
Pro/3 Series with AcuSense	DS-2CD3T56G2-ISU/SL(C)
Pro/3 Series with AcuSense	DS-2CD3T86G2-4IS(C)
Pro/3 Series with AcuSense	DS-2CD3T86G2-4ISY(2.8mm)(C)(O-STD)
Pro/3 Series with AcuSense	DS-2CD3T86G2-4ISY(4mm)(C)(O-STD)

Pro/3 Series with AcuSense	DS-2CD3T86G2-4ISY(6mm)(C)(O-STD)
Pro/3 Series with ColorVu	DS-2CD3047G2-LS(C)
Pro/3 Series with ColorVu	DS-2CD3087G2-LSU(C)
Pro/3 Series with ColorVu	DS-2CD3347G2-LS(U)(C)
Pro/3 Series with ColorVu	DS-2CD3387G2-LSU(C)
Pro/3 Series with ColorVu	DS-2CD3547G2-LS(C)
Pro/3 Series with ColorVu	DS-2CD3647G2-LZS(C)
Pro/3 Series with ColorVu	DS-2CD3747G2-LZSU(C)

*Note: Models in red font are newly released models.*