

Title:	How to use Chime Function	Version:	V1.2.8	Date:	06/15/2023
Product:	AX Pro, Detectors			Page:	1 of 1

Preparation

1. AX PRO V1.2.8build 230110
2. Detectors
3. Hik-connect App

How to use Chime Function

1. What is Chime Function?

When the alarm control panel is in the disarmed mode and someone passes by the detector, the control panel or the keypad (LCD Keypad, LED Keypad)、 the siren (Indoor Siren/Outdoor Siren)、 the intercom sounder can make a doorbell sound to remind (single tone or continuous tone). This feature is the Chime Function.

2. How does it work?

For example, there are two detectors in Area1: Slim Magnetic Contact, PIR Cam, LED Keypad and LCD Keypad.

Step1: Enable the Chime Function in Slim Magnetic Contact or PIR Cam.

Step2: Enable the Chime Indication in LCD Keypad or LED Keypad

BTW:

LCD Keypad (the firmware should keep equal or higher than V1.0.3) supports Chime Function

LED Keypad (the firmware should keep equal or higher than V1.7.0) supports Chime Function

The LED Keypad /LCD Keypad and Control Panel can make a doorbell sound when the system is disarm and Slim Magnetic Contact or PIR Cam is trigger.

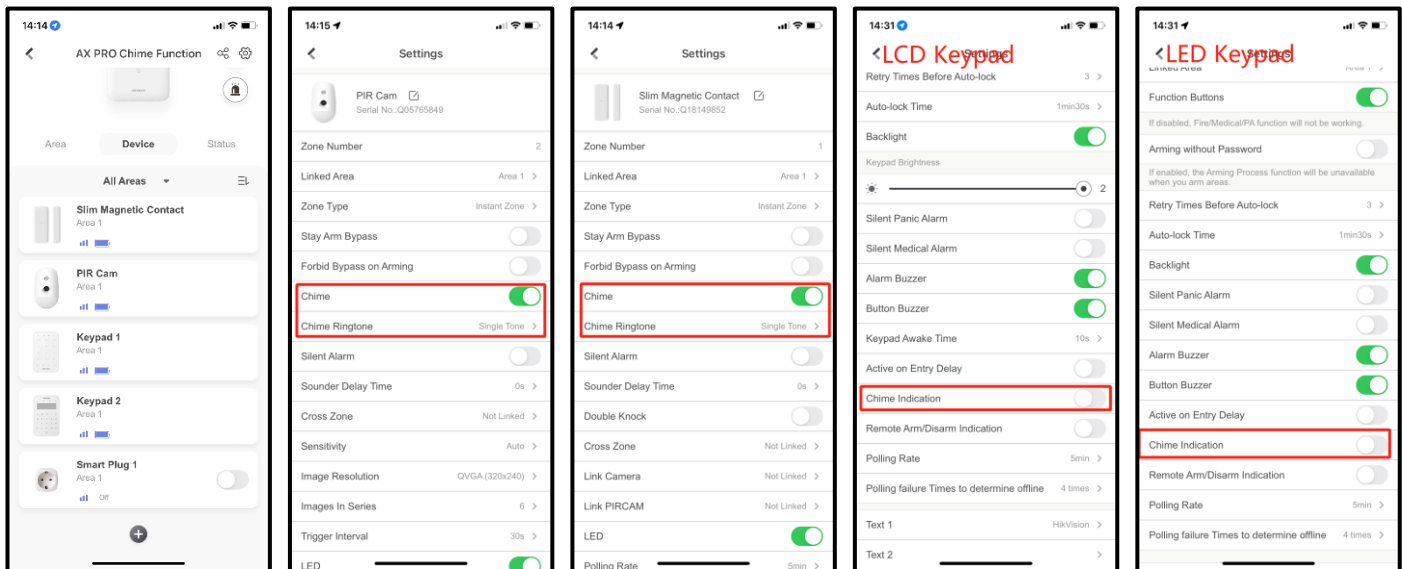



Title:	How to use Chime Function	Version:	V1.2.8	Date:	06/15/2023
Product:	AX Pro, Detectors			Page:	2 of 1

First Choice for Security Professionals
HIKVISION Technical Support