

## Dashcam-G2 User Manual

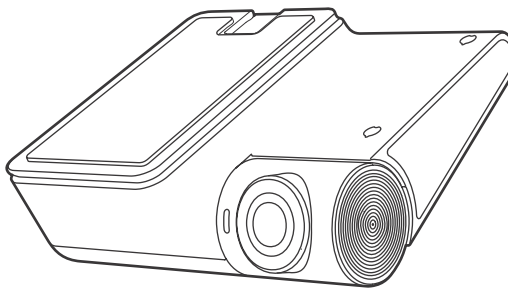

Scan and download the APP

### Regulatory Information

#### FCC Information

Please take attention that changes or modification not expressly approved by the party responsible for compliance could void the user's authority to operate the equipment.

**FCC compliance:** This equipment has been tested and found to comply with the limits for a Class B digital device, pursuant to part 15 of the FCC Rules. These limits are designed to provide reasonable protection against harmful interference in a residential installation. This equipment generates, uses and can radiate radio frequency energy and, if not installed and used in accordance with the instructions, may cause harmful interference to radio communications. However, there is no guarantee that interference will not occur in a particular installation. If this equipment does cause harmful interference to radio or television reception, which can be determined by turning the equipment off and on, the user is encouraged to try to correct the interference by one or more of the following measures:

- Reorient or relocate the receiving antenna.
- Increase the separation between the equipment and receiver.
- Connect the equipment into an outlet on a circuit different from that to which the receiver is connected.
- Consult the dealer or an experienced radio/TV technician for help.

This equipment should be installed and operated with a minimum distance 20cm between the radiator and your body.

1

### Regulatory Information

#### FCC Conditions

This device complies with part 15 of the FCC Rules. Operation is subject to the following two conditions:

1. This device may not cause harmful interference.
2. This device must accept any interference received, including interference that may cause undesired operation.

#### EU Conformity Statement

<b>CE</b>	This product and - if applicable - the supplied accessories too are marked with "CE" and comply therefore with the applicable harmonized European standards listed under the RE Directive 2014/53/EU, the EMC Directive 2014/30/EU, the LVD Directive 2014/35/EU, the RoHS Directive 2011/65/EU
-----------	---

	2012/19/EU (WEEE directive): Products marked with this symbol cannot be disposed of as unsorted municipal waste in the European Union. For proper recycling, return this product to your local supplier upon the purchase of equivalent new equipment, or dispose of it at designated collection points. For more information see: <a href="http://www.recyclethis.info">www.recyclethis.info</a>
--	---

2

### Regulatory Information

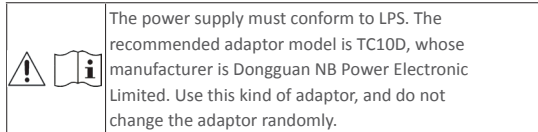

#### Industry Canada ICES-003 Compliance

This device meets the CAN ICES-3 (B)/NMB-3(B) standards requirements.

This device complies with Industry Canada licence-exempt RSS standard(s). Operation is subject to the following two conditions:

- (1) this device may not cause interference, and
- (2) this device must accept any interference, including interference that may cause undesired operation of the device.

Le présent appareil est conforme aux CNR d'Industrie Canada applicables aux appareils radioexempts de licence. L'exploitation est autorisée aux deux conditions suivantes :

- (1) l'appareil ne doit pas produire de brouillage, et
- (2) l'utilisateur de l'appareil doit accepter tout brouillage radioélectrique subi, même si le brouillage est susceptible d'en compromettre le fonctionnement.

Under Industry Canada regulations, this radio transmitter may only operate using an antenna of a type and maximum (or lesser) gain approved for the transmitter by Industry Canada. To reduce

3

### Regulatory Information

potential radio interference to other users, the antenna type and its gain should be so chosen that the equivalent isotropically radiated power (e.i.r.p.) is not more than that necessary for successful communication.

Conformément à la réglementation d'Industrie Canada, le présent émetteur radio peut

fonctionner avec une antenne d'un type et d'un gain maximal (ou inférieur) approuvé pour l'émetteur par Industrie Canada. Dans le but de réduire les risques de brouillage radioélectrique à l'intention des autres utilisateurs, il faut choisir le type d'antenne et son gain de sorte que la puissance isotrope rayonnée équivalente (p.i.r.e.) ne dépasse pas l'intensité nécessaire à l'établissement d'une communication satisfaisante.

This equipment should be installed and operated with a minimum distance 20cm between the radiator and your body. Cet équipement doit être installé et utilisé à une distance minimale de 20 cm entre le radiateur et votre corps.

4

### A Packing List

1. Dashcam x 1
2. Power Cord x 1
3. Bluetooth Remote Control x 1
4. TVI Camera (Optional) x 1
5. Electrostatic Film x 2
6. User Manual x 1
7. 3M Tape x 2

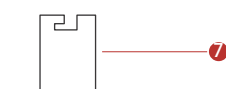
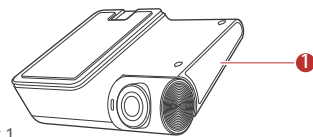

5

### B Appearance Description

1. TF Slot  
Insert the TF card for recording.
2. RESET  
Press to re-start the device when powered on.
3. Parked Indicator  
Device turns to parked monitoring mode when the motor stopped. Indicator is steady red.
4. Lens
5. MINI USB Interface  
For connecting 4G module
6. Micro USB Interface  
For connecting power cord
7. TVI Camera Interface
8. MIC
9. Power/Status Indicator
10. Audio Output

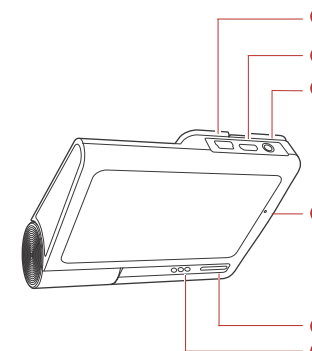
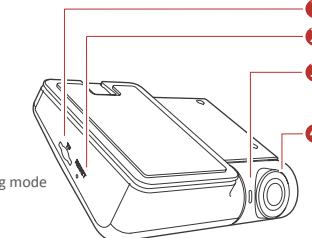

6

### C Installation

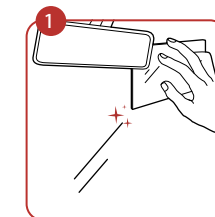

Clean the windshield and paste the electrostatic film onto it. Avoid introducing air bubble.

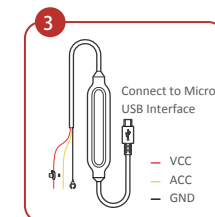

Connect the power cord as the figure above.

**i** (Optional) Install TVI camera and connect to the device according to specific manual. Slide the device along the arrow in step 4 to remove.

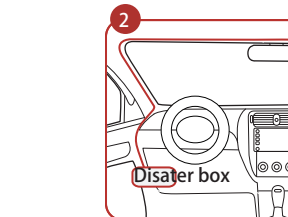

Paste the device onto the electrostatic film and route cable to the disater box for power supply.

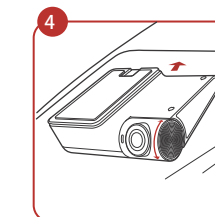

Adjust the angle to the target direction.

7

## D Mobile Phone Connection

1 Scan the QR code to download the HikDashcam app.



2

Add the dashcam in app by connecting to its Wi-Fi.  
 Step 1 .Run the HikDashcam app.  
 Step 2 .In Wi-Fi list, select the Wi-Fi name of target dashcam and enter WiFi password to build connection.

i

Dashcam Wi-Fi default parameters:

- Wi-Fi name: HIKVISION-XXXX (XXXX refers to the last four characters of verification code.)
- Wi-Fi password: 1234567890

## E Basic Operation

### Start up

Connect the power cord to the car battery.  
 Device starts recording automatically once the car started .

i

When the car is off, device turns into parked monitoring mode and start to record once the current scene changed or collision happened.

### Bluetooth Remote Control

You can start recording and capturing via bluetooth remote control after connect to bluetooth.

- Press the capture button to capture and save a picture.
- Linkage Recording: Once enabled, a 12-second video involving 6 seconds before and 6 seconds after the capture will be saved.
- Remote-Control Installation: it's suggested to install the remote control to where you can operate easily, such as the underside of steering wheel.

i

Avoid the airbag when installing the remote control for your safety.

## E Basic Operation

Device displays the real-time .  
 Slide horizontally to change the channel (with 2nd camera connected).

- Slide down at the main interface to turn on/off the Wi-Fi, bluetooth, GPS, speaker and recording.
- Tap the screen and slide left to display the main menu. You can check video, image or set parameters.

### Recording

You can set the video voice on/off via the 3 ways below:

- Option1: Turn on/off the voice via click the bluetooth remote control.
- Option2: Enter **System Settings ->Video Parameter-> Voice in Recording**, to set the voice.
- Option3: Turn on/off the voice via Hikdashcam APP.

### Set the Calibration Line

Adjust the calibration line to improve the veracity of ADAS.

- Step1: Park the car to an open field.
- Step2: Slide right to open the calibration interface
- Step3: Adjust the angle of the lens make the calibration line coincide with the the horizon line.

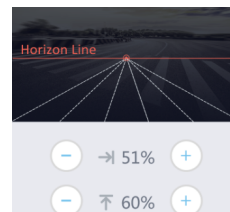

## E Basic Operation

Slide left the main interface to open the main menu, tap **System settings** to set system parameters.

### Update

- Option1 : Through Hikdashcam APP  
 Step1: Power on the device and open Wi-Fi to connect the APP.  
 Step2: Check the latest SW version in the APP.  
 Step3: Choose **System Settings -> SW Update** to start update.  
 Step4: Device restarts once the firmware started.

- Option2: Connect the device to 4G network, device detects the latest SW version. You can download and update accordingly. (It needs to compatible with 4G module).

i Don't cut off the power during upgrading.

### ADAS

Tap **ADAS** to turn on several intelligent auxiliary driving functions involving collision warning, green light prompt, etc.

### Other Parameters

- Check the device and SW version at **System Setting->About**.
- Set resolution at **Video Recording**.
- Turn on/off **WDR/Distortion Correction** in Image Parameter. It's suggested to open WDR when against the light.

• **Format SD Card:** clear the data in the SD card.

• After **G-sensor** enabled, device makes a video once the car has an emergent brake or turn.

## F Preventions and Cautionary Tips

### Tips for Dashcam

- Use the original power cord in the package for power supply.
- Dashcam supports to record and save vehicle accident recordings, but doesn't guarantee to record all the accidents.
- Operate the dashcam in accordance with the local regulations and laws.
- Save the user manual properly for future reference.
- In case the dashcam is directly connected with the automobile power system, you are recommended to power off the dashcam when the automobile is off.
- Working temperature: [-20°C, +65°C ] ([-4°F, 149°F]). To protect the dashcam, do not use it in high-humidity and high-dust density environment and keep all liquids away from it.
- The user manual is subject to the dashcam update.

## F Preventions and Cautionary Tips

### Tips for TF Card

- For the stability and efficiency of data storage, Please purchase TF cards from official channels. It is recommended to use a high-speed TF card of class 10 or above, and its capacity should be no less than 16 G.
- Shut down the device before installing and uninstalling the TF card.
- It is recommended to format the TF card once a month.
- Please replace the TF card regularly to avoid the TF card exceeding its service life and unable to store data.

## H Trouble Shooting

Trouble	Solution
The dashcam drops easily.	• Clean the glass before installation.
Starting dashcam failed.	• Ensure the automobile started normally and the power supply is normal. • If no indicator is lighting, re-connect the power cord.
The dashcam powers off frequently.	• Ensure the power cord is well. • Ensure the connection between dashcam and power cord is well.
Recording is abnormal and recording indicator is unlit.	• Ensure the dashcam is started normally. • Ensure TF card is installed. • Check TF card status, e.g., its format and lifespan. If it is not well,replace it with a good one.
Recorded videos are fuzzy.	• Tear off the proof film on lens. • Clean the lens and glass.
Audio is not recorded with video.	• Enable "Tape When Recording".
Connecting the dashcam via app failed.	• Ensure the app is well installed. • Restart the app and dashcam.

## H Trouble Shooting

Trouble	Solution
Playing video via app failed.	• The trouble may be relevant with the mobile phone player or system.Read TF card and play the videos via PC. It needs a specific player to read and play the recordings.
Failed to detect the TF card when connecting the dashcam and your computer with the power cord.	• The dashcam does not support data transmission. And the power cord is only for charging. If you need to transfer data, take out the TF and connect it to your computer.
It takes a long time to connect the dashcam WiFi.	• It may be caused by the interference of the surrounding Wi-Fi signals. You can operate the dashcam in an environment with less interference. • Close unnecessary programs in your mobile phone to release some resources for the dashcam app.