

DS-K1T343 Series MinMoe Terminal

Release Notes (2023-08-09)

Device Model: DS-K1T343EX, DS-K1T343EWX DS-K1T343EFX, DS-K1T343EFWX DS-K1T343MX, DS-K1T343MWX DS-K1T343MFX, DS-K1T343MFWX Naming Rule: M for M1 card, F for fingerprint, W for Wi-Fi	Firmware Version ACS_343_F1pro_EN_NEU_V3.14.2_build230802 ACS_343_F1pro_EN_STD_V3.14.2_build230802
	HikCentral AC: https://www.hikvision.com/en/support/download/software/hikcentral-access-control-v2-0-1/

Reason of Upgrade

Fix bugs, enhance products quality and meet customers' requirements.

Modified Features

1. User friendly UI design

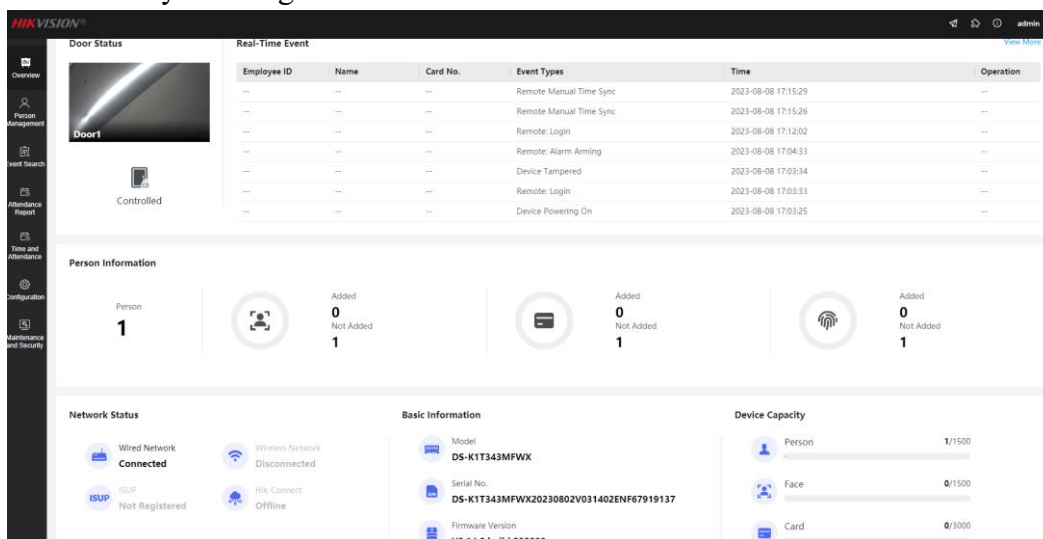

2. PIN Code supports switching between platform applied personal PIN mode and device set personal PIN mode

Notice :

Open web client, go to Configuration-Security-Password mode to switch PIN Code mode. In platform applied mode, cannot edit PIN Code on web client, it needs to be set on platform. In device set mode, can edit PIN Code on web client or local UI and PIN code set by platform is invalid.

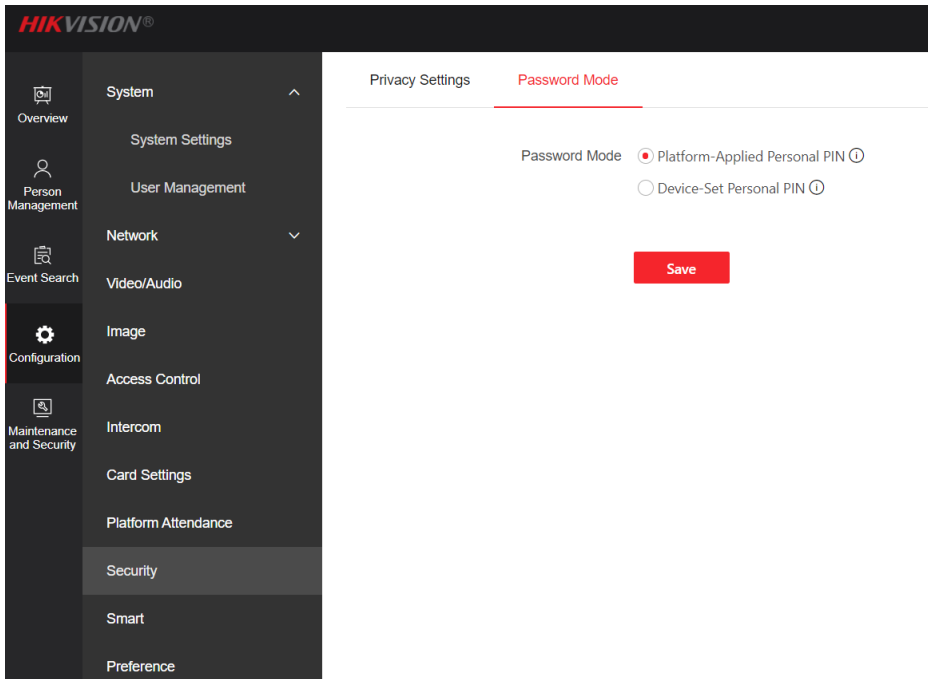

3. Supports local T&A function.

- a. Platform attendance will be disabled automatically after local T&A is enabled, vice versa
- b. Supports set up attendance rule via 3 methods: PC web, mobile web, local menu
- c. Supports 5 types of attendance report: Summary Report, Abnormal Attendance, Attendance Card, Attendance Record, Shift Schedule
- d. Supports 3 methods to export attendance report: PC web, mobile web and USB drive

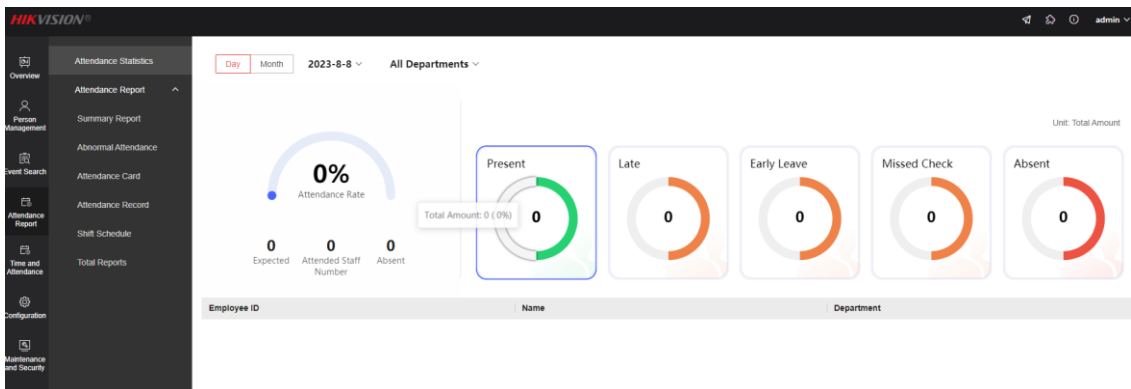
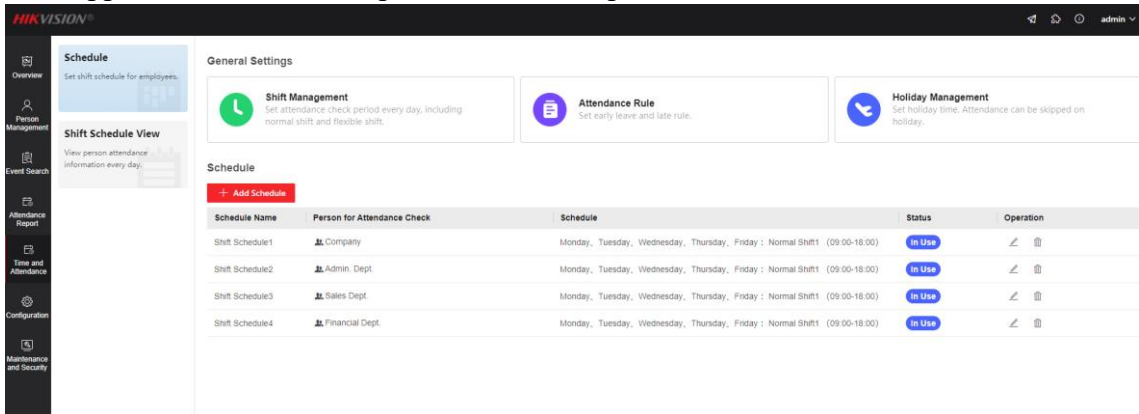

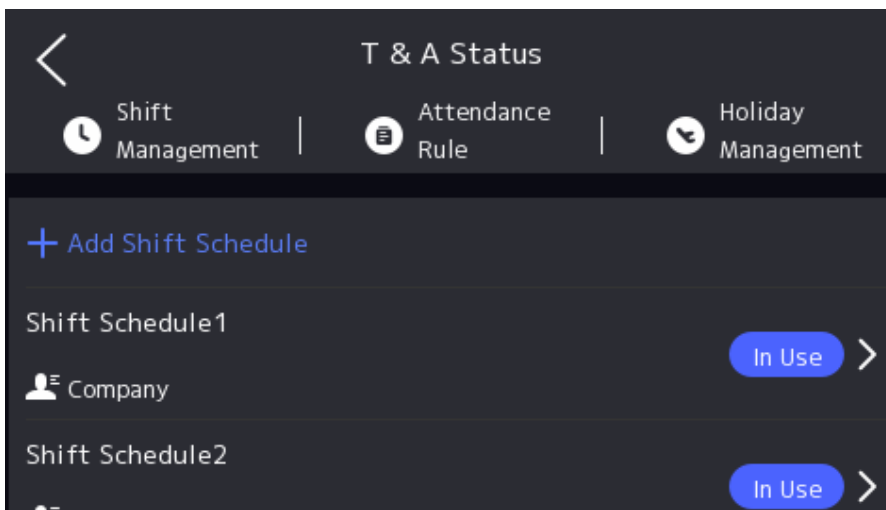
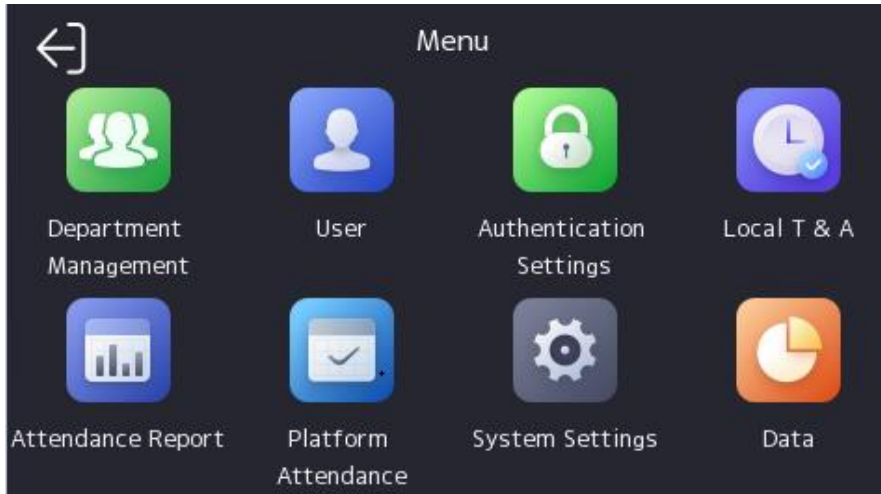

4. Support sync person information to platform automatically

Notice:

- Platform requirement: HCP V2.4.1 or HCAC V2.1.1
- Only ISAPI or ISUP protocol supported
- Need to set up on platform first. If you enable this function , changes of the person information will be synced from the device to the platform automatically

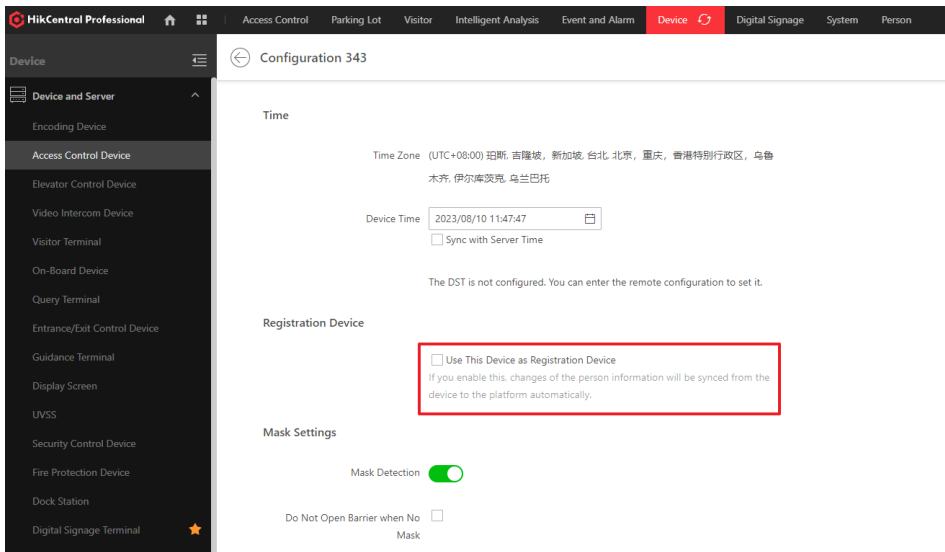

5. Supports modifying device password locally

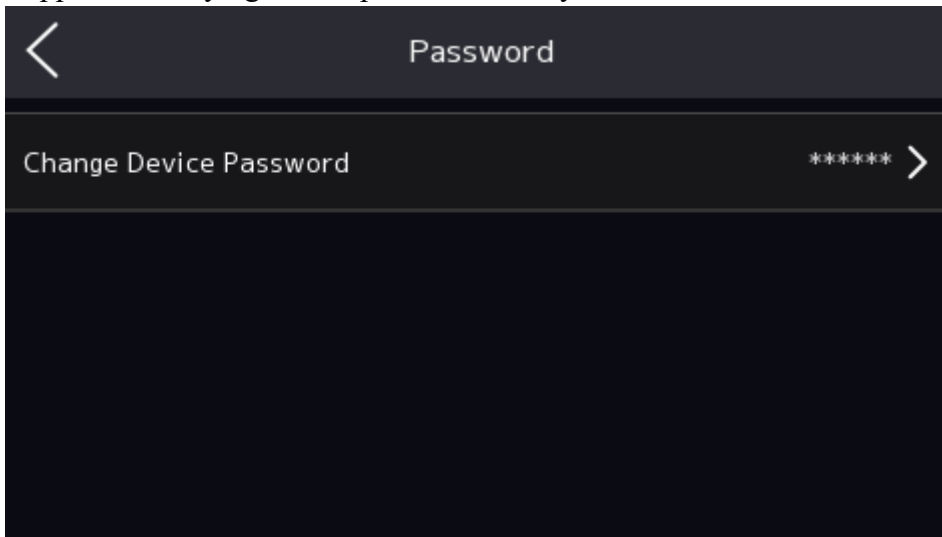

6. Supports enable M1 encryption locally

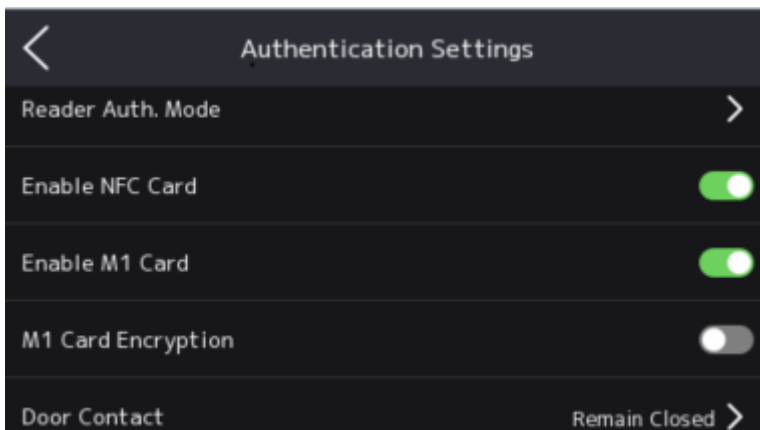

7. Support modify I frame interval(NTSC 30 or PAL 25) both on web and local menu.

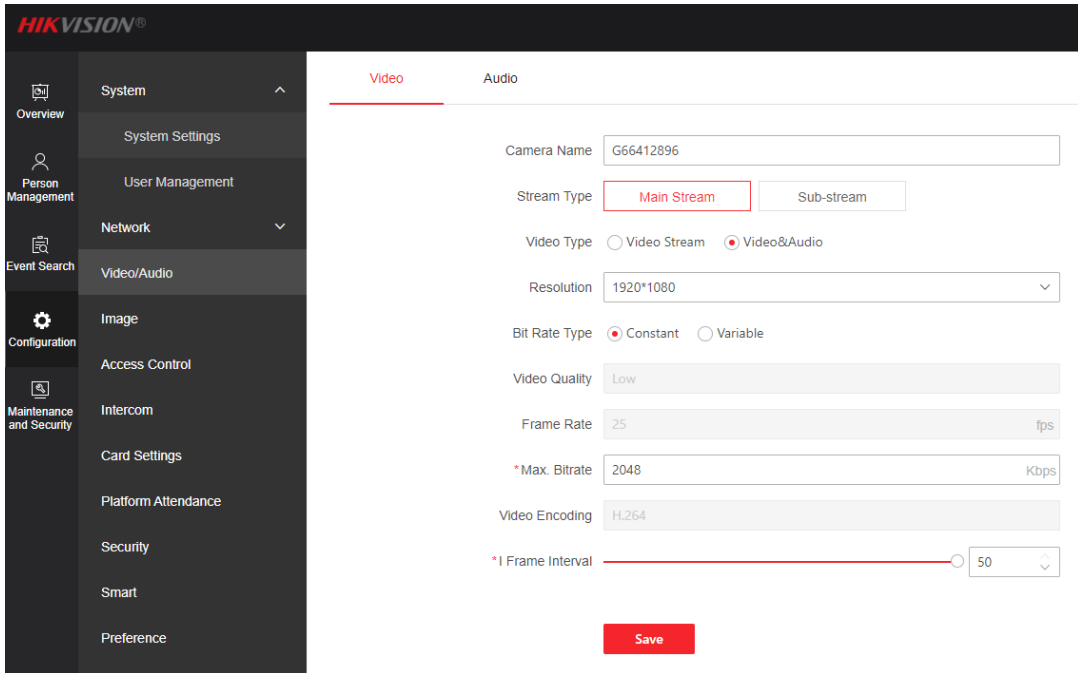

8. Supports 2 anti-spoofing detection level: **General** and **Advanced**. It supports customizing anti-spoofing detection threshold in advanced settings

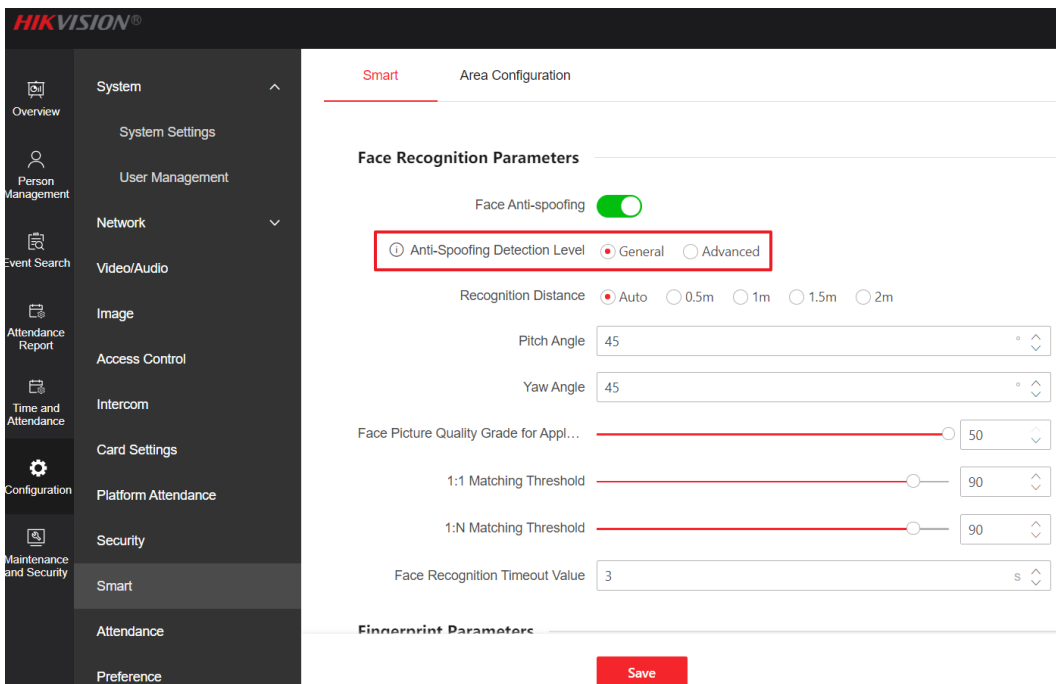

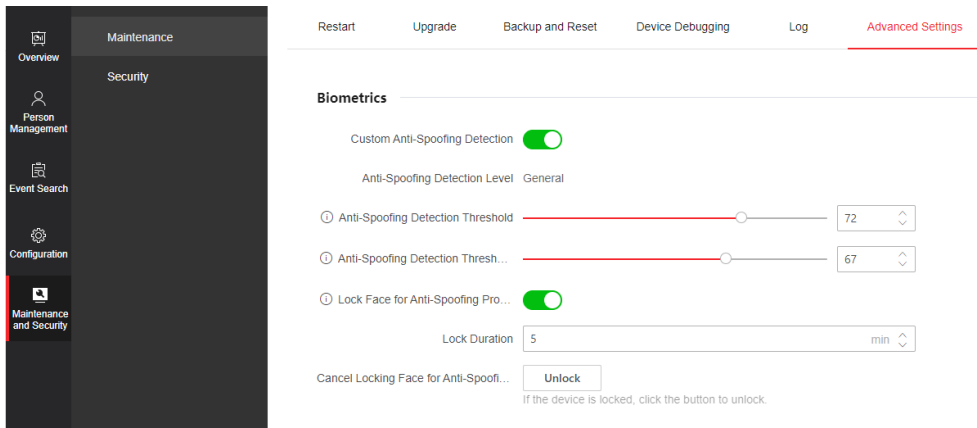

- 9. Supports QR code 2.0
- 10. Supports capture network packet on web client

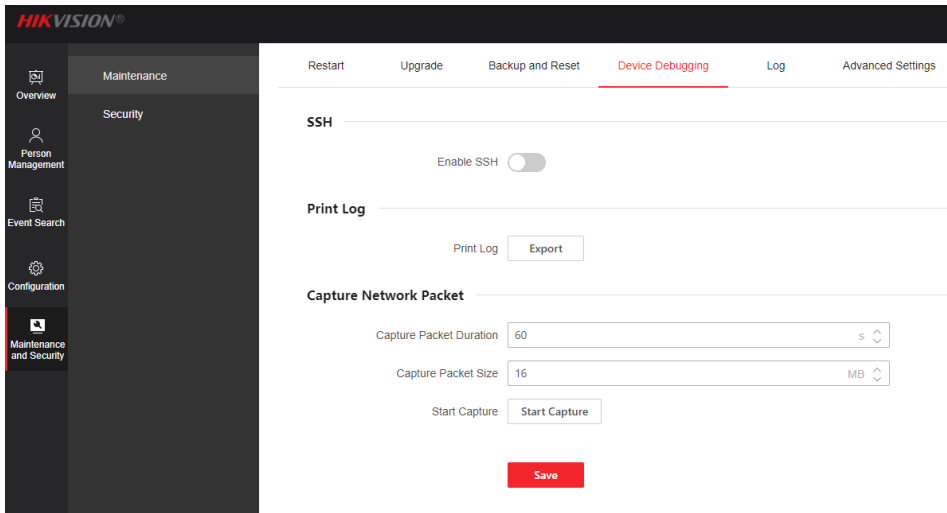

DS-K1T343 Series MinMoe Terminal Release Notes (2023-06-14)

<p>Device Model: DS-K1T343EX, DS-K1T343EWX DS-K1T343EFX, DS-K1T343EFWX DS-K1T343MX, DS-K1T343MWX</p>	<p>Firmware Version</p>	<p>ACS_343_F1pro_EN_STD_V3.14.0_build230331 ACS_343_F1pro_EN_NEU_V3.14.0_build230331</p>
---	--------------------------------	--

DS-K1T343MFX, DS-K1T343MFWX Naming Rule: M for M1 card, F for fingerprint, W for Wi-Fi	SDK	Latest baseline version
	iVMS-4200 Version	Latest baseline version

Reason of Upgrade

Fix bugs, enhance products quality and meet customers' requirements.

Modified Features

11. Fixed known security vulnerabilities

for details, please refer:

<https://www.hikvision.com/en/support/cybersecurity/security-advisory/security-vulnerability-in-some-hikvision-access-control-intercom/>

DS-K1T343 Series MinMoe Terminal Release Notes (2022-04-09)

Device Model: DS-K1T343EX, DS-K1T343EWX DS-K1T343EFX, DS-K1T343EFWX DS-K1T343MX, DS-K1T343MWX DS-K1T343MFX, DS-K1T343MFWX Naming Rule: M for M1 card, F for fingerprint, W for Wi-Fi	Firmware Version	ACS_343_F1pro_EN_STD_V3.3.4_build220310 ACS_343_F1pro_EN_NEU_V3.3.4_build220310
	SDK	Latest baseline version
	iVMS-4200 Version	Latest baseline version

Reason of Upgrade

Fix bugs, enhance products quality and meet customers' requirements.

Modified Features

12. Optimize fingerprint module performance.

DS-K1T343 Series MinMoe Terminal Release Notes (2022-03-09)

Device Model: DS-K1T343EX, DS-K1T343EWX DS-K1T343EFX, DS-K1T343EFWX DS-K1T343MX, DS-K1T343MWX DS-K1T343MFX, DS-K1T343MFWX Naming Rule: M for M1 card, F for fingerprint, W for Wi-Fi	Firmware Version	ACS_343_F1pro_EN_STD_V3.3.4_build220210 ACS_343_F1pro_EN_NEU_V3.3.4_build220210
	SDK	Latest baseline version
	iVMS-4200 Version	Latest baseline version

Reason of Upgrade

Fix bugs, enhance products quality and meet customers' requirements.

Modified Features

13. Fix the problem that the device cannot wake up occasionally after running for a long time;

DS-K1T343 Series MinMoe Terminal Release Notes (2022-02-09)

Device Model: DS-K1T343EX, DS-K1T343EWX DS-K1T343EFX, DS-K1T343EFWX DS-K1T343MX, DS-K1T343MWX	Firmware Version	ARM : ACS_343_F1pro_EN_STD_V3.3.4_build211229 ACS_343_F1pro_EN_NEU_V3.3.4_build211229
---	------------------	--

DS-K1T343MFX, DS-K1T343MFWX Naming Rule: M for M1 card, F for fingerprint, W for Wi-Fi	SDK	Latest baseline version
	iVMS-4200 Version	Latest baseline version

Reason of Upgrade

Fix bugs, enhance products quality and meet customers' requirements.

Modified Features

1. Update the driver to be compatible with new fingerprint materials;
2. Fix some ISAPI protocol bugs

DS-K1T343 Series MinMoe Terminal Release Notes (2021-10-23)

Device Model: DS-K1T343EX, DS-K1T343EWX DS-K1T343EFX, DS-K1T343EFWX DS-K1T343MX, DS-K1T343MWX DS-K1T343MFX, DS-K1T343MFWX Naming Rule: M for M1 card, F for fingerprint, W for Wi-Fi	Firmware Version	ARM : ACS_343_F1pro_EN_STD_V3.3.4_build211022 ACS_343_F1pro_EN_NEU_V3.3.4_build211022
	SDK	Latest baseline version
	iVMS-4200 Version	Latest baseline version

Reason of Upgrade

Fix bugs, enhance products quality and meet customers' requirements.

Modified Features

3. Update the driver to be compatible with new fingerprint materials;

DS-K1T343 Series MinMoe Terminal Release Notes (2021-09-17)

Device Model: DS-K1T343EX, DS-K1T343EWX DS-K1T343EFX, DS-K1T343EFWX DS-K1T343MX, DS-K1T343MWX DS-K1T343MFX, DS-K1T343MFWX Naming Rule: M for M1 card, F for fingerprint, W for Wi-Fi	Firmware Version	ARM : ACS_343_F1pro_EN_STD_V3.3.4_build210812 ACS_343_F1pro_EN_NEU_V3.3.4_build210812
	SDK	Latest baseline version
	iVMS-4200 Version	Latest baseline version

Reason of Upgrade

New model DS-K1T343 series MinMoe terminal first time released.



New Features

- 4.3 inch capacitive touch screen with large screen ratio, 2 MP wide-angle dual-lens camera with WDR feature;
- Connect external card reader or access controller via RS485 protocol; support Wiegand26/34 output
- Face recognition duration < 0.2 s/User; face recognition accuracy rate ≥ 99%
- Face, card, fingerprint, event capacity**

	Face	Card	Fingerprint	Event	Wi-Fi
DS-K1T343EX	1,500	3,000(EM)	Not support	150,000	Not support
DS-K1T343EWX			Not support		Support
DS-K1T343EFX			1,500		Not support
DS-K1T343EFWX			1,500		Support
DS-K1T343MX		3,000(M1)	Not support		Not support
DS-K1T343MWX			Not support		Support
DS-K1T343MFX			1,500		Not support
DS-K1T343MFWX			1,500		Support

5. **ISAPI** protocol makes it easier for integration with third-party software;
6. Remote video intercom and unlock door from **Hik-Connect App** on your mobile/Pad
7. Support **Hik-ProConnect** platform to realize Cloud access control and time attendance management
8. Support **ISUP 5.0** protocol to manage devices located in different locations;
9. When open device for the first time, wizard for activation and basic configuration. Including select language, application mode, select and configure network, Hik-Connect, privacy settings, add administrator face and card

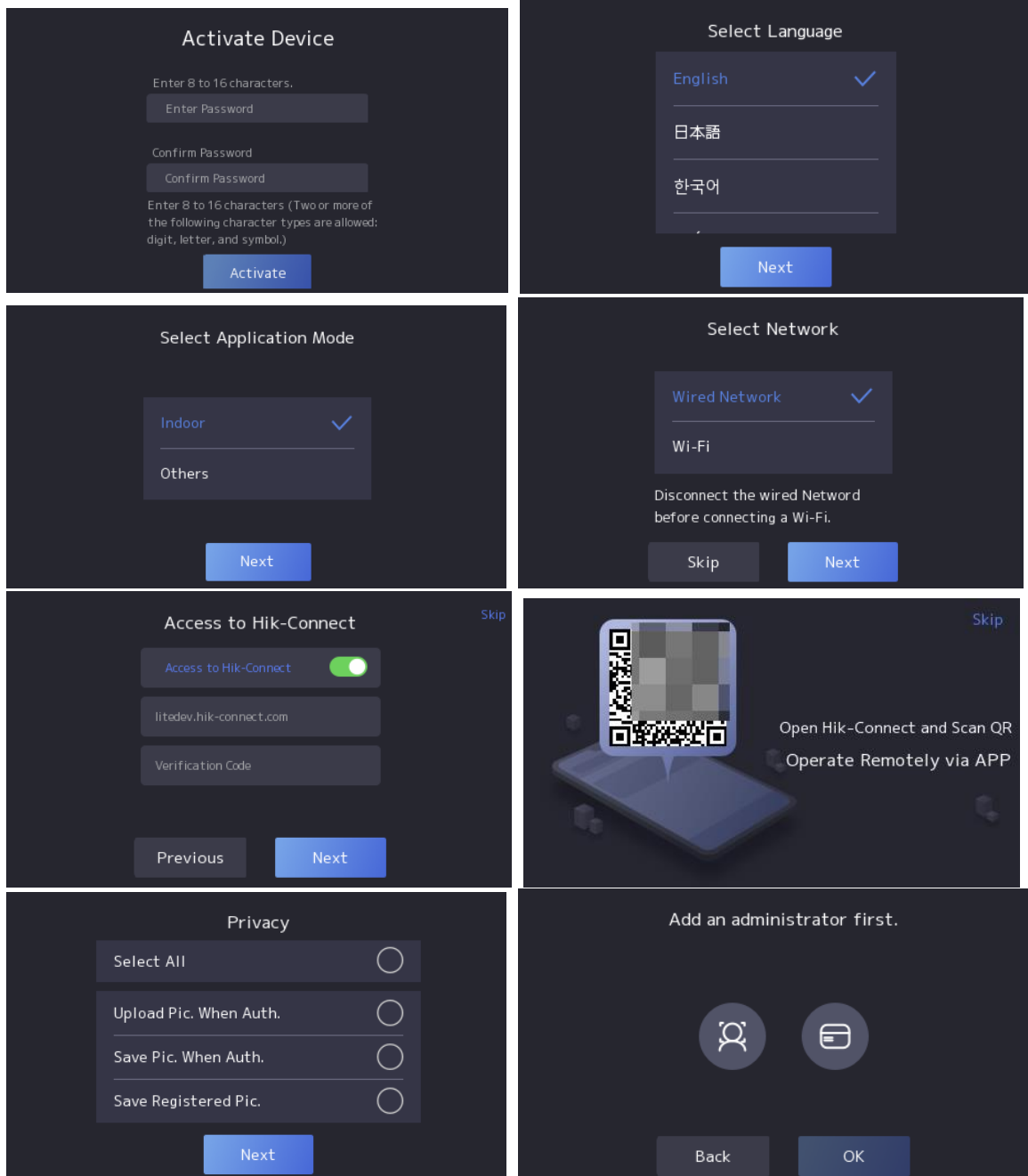

10. Self-defined shortcut key (Call Room, Call Center, Call Specified Room, Call App and Password) on main interface;

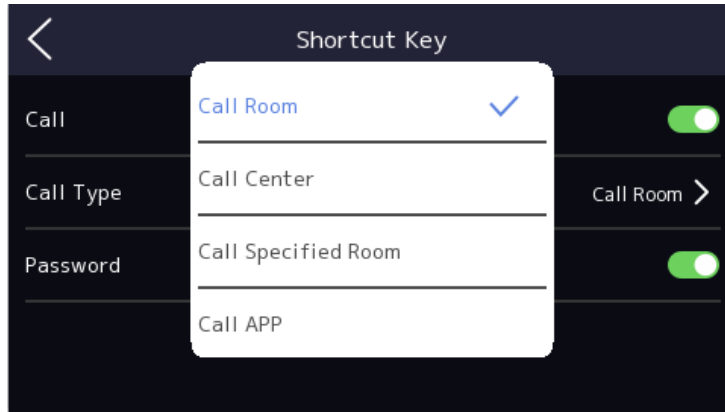

11. Configure ISUP and Hik-Connect parameter in device local menu

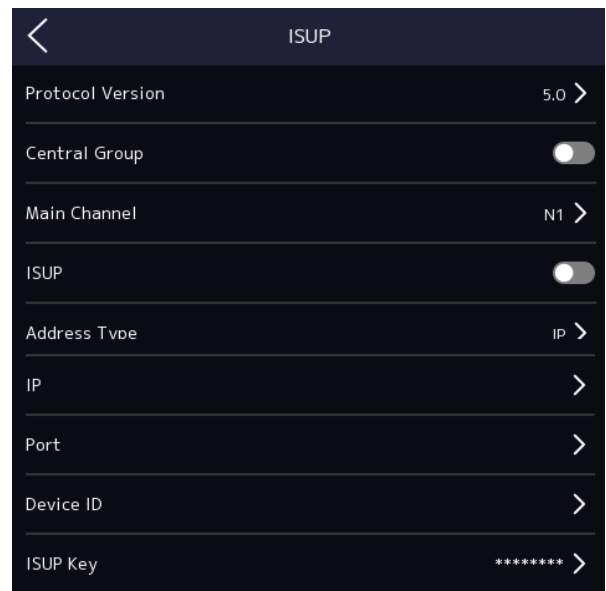
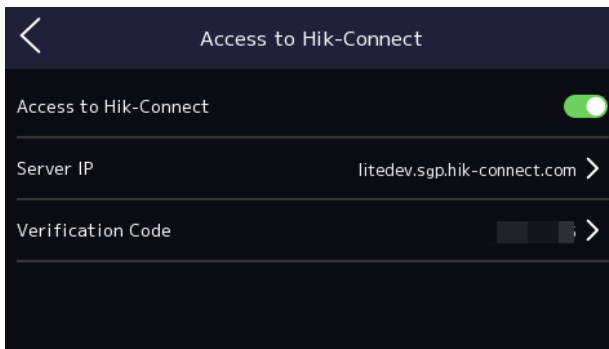
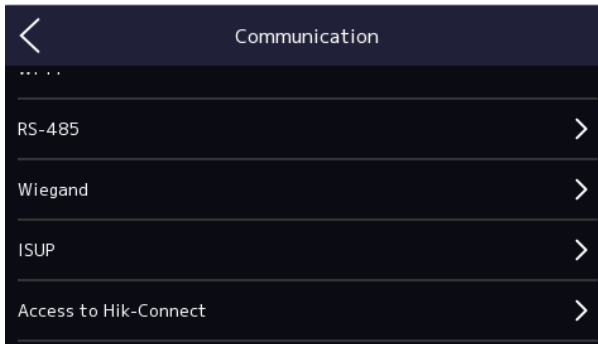

12. Login and configure device in web client via **PC/mobile browser**;(mobile phone should connect same network with device)

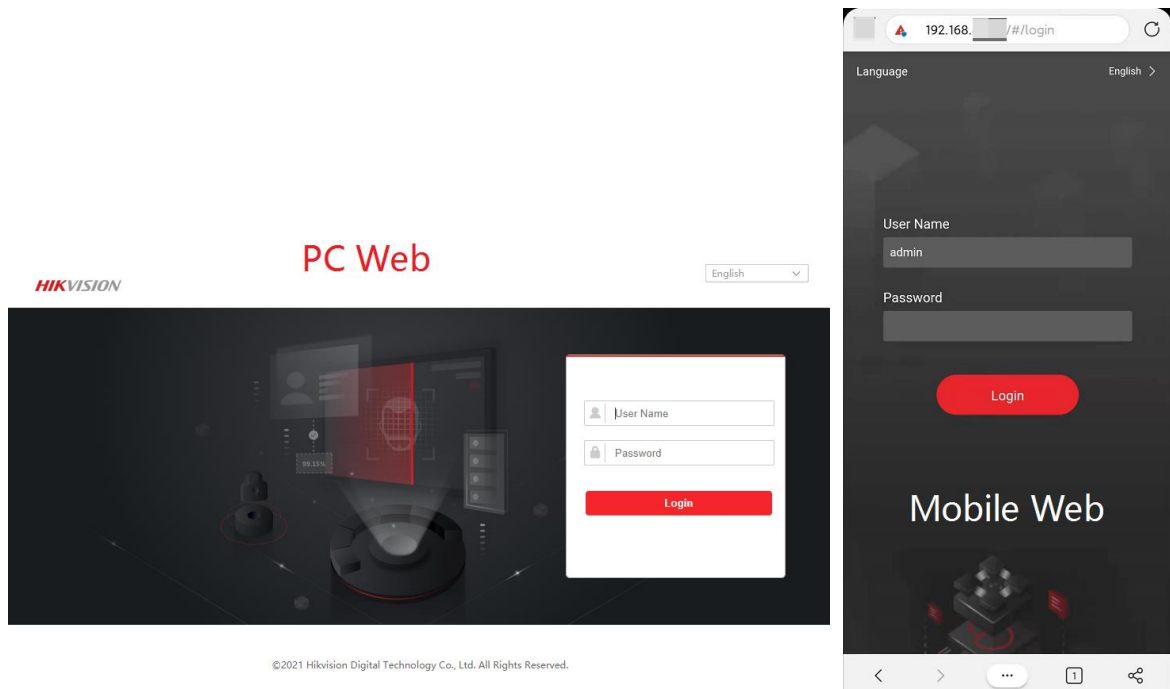

13. Self-defined voice prompt (TTS function, English only) and screen display info (user ID, name and face picture) for authentication;

14. Network

Support TCP/IP, adapt to LAN(network) or WAN(ISUP 5.0) network environment

15. Function

- a. Support face mask recognition.
- b. **Video intercom** with indoor station, master station and platform;
- c. Multiple verification modes: Face, card, fingerprint(-F only), PIN code;
- d. Face recognition distance ranges from 0.3 to 1.5 meters;
- e. Support check in/check out/break out/break in/overtime in/overtime out attendance status, and self-define status name;

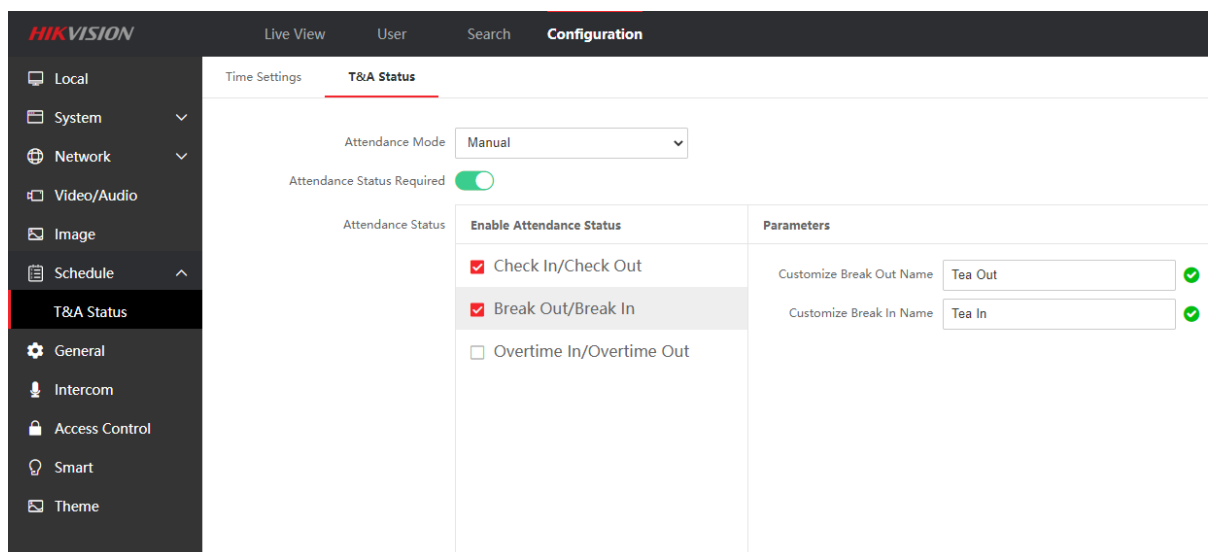

- f. Support custom standby background image (max 8 pictures)

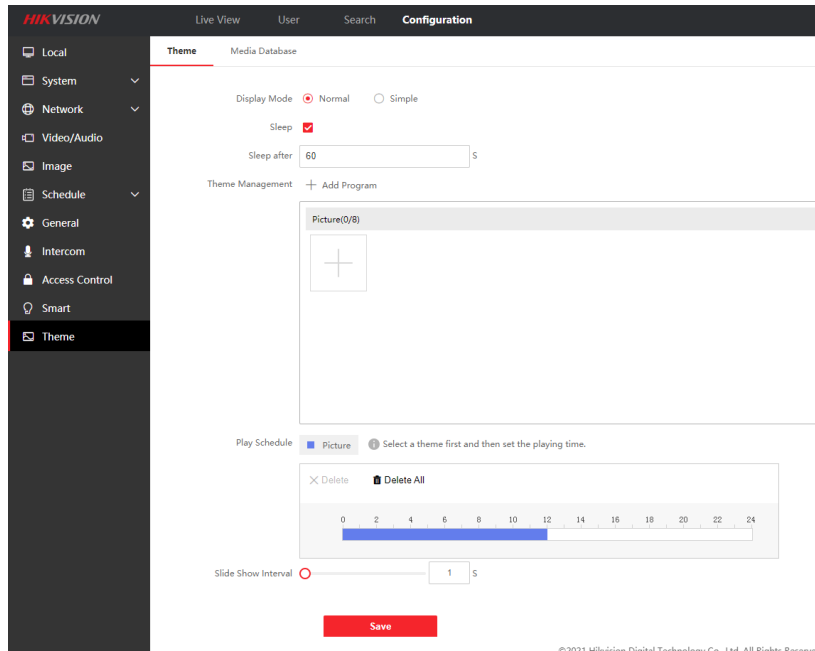

- g. Support privacy protection, customer can define the privacy related parameter, such as Event Storage Settings, Picture Uploading and Storage, Clear All Pictures in Device

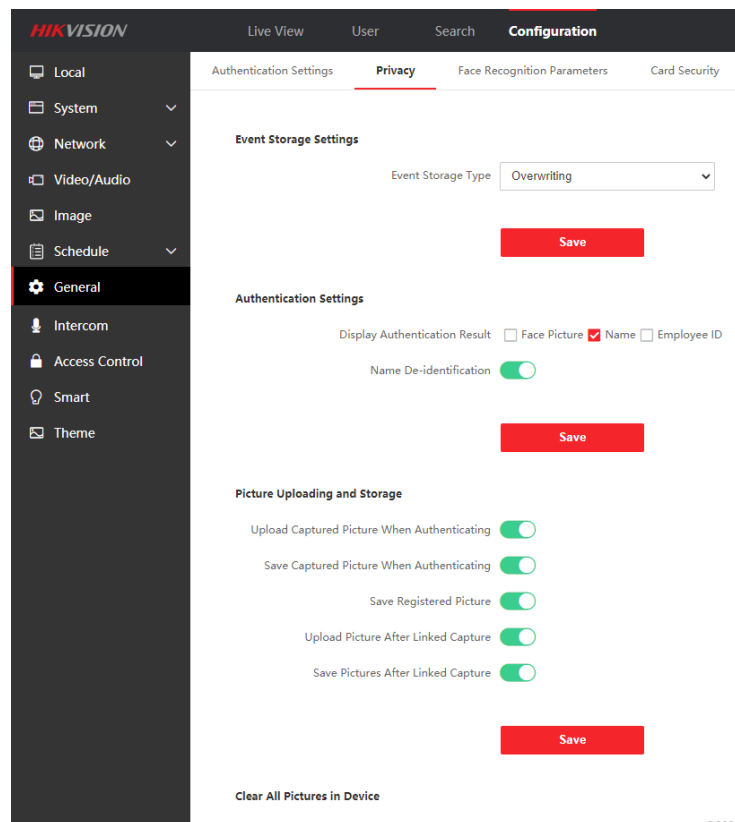

- h. Supports face recognition in low illumination
- i. Supports live view on the platform, H.264

Customer Impact and Recommended Action

This update refers to function/compatibility improvement and will take effect automatically after the Date of Change. We are very sorry for any inconvenience of use-habit changes caused by this action. For any questions and request for this firmware, please contact our local technical support team.

Note:

- Hikvision reserves the right to change, alter or withdraw the above notification without prior notice.
- Product design and specifications are subject to change without prior notice.
- The Hikvision firmware may contain errors known as errata, which may cause the product to deviate from published specifications. Current characterized errata are available on request.
- Hikvision is not liable for any typing or printing errors.

Hikvision Digital Technology CO., Ltd.
No. 555 Qianmo Road, Binjiang District, Hangzhou 310051,
China
Tel: +86-571-8807-5998
FAX: +86-571-8993-5635
Email: overseabusiness@hikvision.com