

WS4959 12 Channel Wireless Key

Operating Instructions

Congratulations on the purchase of the WS4959, the industry's first 12 channel remote control. This key will allow you to arm and disarm as well as control open and close garage doors and security gates or virtually any remote function you can think of. This is the perfect remote to add to DSC's new garage relay module with integrated laser parking (RXL2-433) to control anything that can be turned ON or OFF.

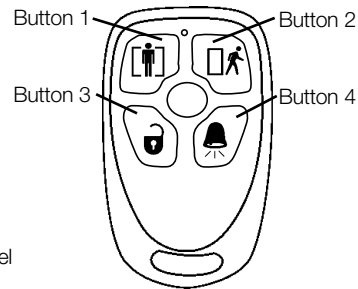

Operation of the WS4959

The small center button on the WS4959 is used as a level shift to move from channels 1-4 to 5-8 and 9-12.

- 1) Press and hold the center button of the WS4959
 - 2) Watch as the LED on the WS4959 changes from green to amber and back to red. The RED LED indicates channels 1-4, the GREEN LED indicates channels 5-8 and the AMBER indicates channels 9-12*.
 - 3) When you see the appropriate color LED release the center button. The LED will pulsate that color to indicate that you are in the appropriate channels. Press one of the four buttons and the LED will stop flashing and will default back to channels 1-4.
- NOTE: The WS4959 always defaults to channels 1-4 so it is NOT necessary to hold the center button to access channels 1-4. If you are in Channels 5-8 or 9-12 the unit will "time out" after 5 seconds if no buttons are pressed.
 - Pressing and holding a key will continuously transmit that function

The default functions are as follows:



Stay Arming Press this button to arm your system in the Stay mode. All perimeter zones will be armed, such as all window and door contacts, but the interior zones will remain inactive, allowing you to stay on the premises without setting off an alarm.



Away Arming Press this button to arm your system in the Away mode. Both the interior and exterior zones will be armed, allowing you to exit the premises.



Disarm Press this button to disarm your system. You do not have to enter your access code when you use the key to disarm the system.



Panic Press and hold this button to notify your central monitoring station of a situation requiring the police, such as a break-in.

Note: By default, the user must press and hold the button for 3 seconds to activate the auxiliary function.

Replacing the Batteries

Under normal conditions the batteries can last up to 5 years. If the battery is low the trouble light on the control panel's keypad will turn ON.

To replace the battery, remove the top cover by inserting a coin into the slot located on the bottom right corner and twist. Remove the screw at the center of the board to expose the batteries.

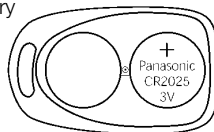

Replace both batteries with Panasonic CR-2025 lithium batteries (see diagram).

NOTE: The polarity of the battery must be observed, as shown in the diagram above. Improper handling of lithium batteries may result in heat generation, explosion or fire, which may lead to personal injuries.

WARNING: DANGER OF EXPLOSION IF BATTERIES ARE INSTALLED INCORRECTLY. REPLACE ONLY WITH THE SAME OR EQUIVALENT TYPE RECOMMENDED BY THE MANUFACTURER.

Keep away from small children. If Batteries are swallowed, promptly see a doctor. Do not try to recharge these batteries. Disposal of used batteries must be made in accordance with the waste recovery and recycling regulations in your area.

How to Enroll the WS4959

To enroll channels 1-4, use the 6 digit serial number printed on the back of the WS4959. To enroll channels 5-8 add '1' to the serial number and for channels 9-12 add '2' to the serial number. For example if the serial number printed in the back of the remote is 612345.

- 612345 Channel 1-4 (Buttons 1-4 on the front)
- 612346 Channel 5-8 (Level shift to GREEN LED and use buttons 1-4 on the front)
- 612347 Channel 9-12 (Level shift to AMBER LED and use buttons 1-4 on the front)

* If you are using the WS4959 with a DSC wireless relay module (RXL2-433) to interface with garage doors, security gates or lighting controls, you do not need to enroll the serial number since it is a code learning system. Refer to the RXL2-433 manual.

Compatibility

The WS4959 is compatible with the following receivers: RXL2-433, PC4164-433, PC5132-433, RF5108-433, RF5501-433, NT9005

Belt Clip Assembly and Mounting

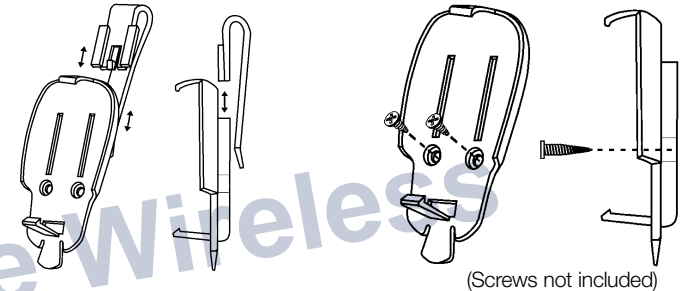

Additional Information

In no event shall Digital Security Controls Ltd. be liable for any direct, indirect or consequential damages, loss of anticipated profits, loss of time or any other losses incurred by the buyer in connection with the purchase, installation or operation or failure of this product.

Warning: Digital Security Controls Ltd. recommends that the entire system be completely tested on a regular basis. However, despite frequent testing, and due to, but not limited to, criminal tampering or electrical disruption, it is possible for this product to fail to perform as expected.

Important Information: Changes or modifications not expressly approved by Digital Security Controls Ltd. could void the user's authority to operate this equipment.

FCC COMPLIANCE STATEMENT

This device complies with Part 15 of the FCC Rules. Operation is subject to the following two conditions: (1) This device may not cause harmful interference, and (2) this device must accept any interference received, including interference that may cause undesired operation.

IC: 160A-WS4959 The term 'IC:' before the radio certification number only signifies that Industry Canada technical specifications were met.



©2004 Digital Security Controls Ltd., Toronto, Canada

Technical Support: 1-800-387-3630 • www.dsc.com
29007051 R001

Direct all comments concerning this publication to pubs@dsciltd.com